

Quality of the Soil, Timber, &c. on the Township Lines.

Description of the Land, Timber, &c. on the Interior Sectional Lines.

East Boundary.		South Boundary.	
Sec. 36	Land chiefly wet prairie	Sec. 36	Land mostly prairie bottom with a heavy growth of grass &c
" 25	Land 3 rd rate Oak timber no U. G. &c	" 35	Land wet prairie, similar but dry, Upland Oak lanous good
" 24	Same	" 34	Land except prairie Marsh, rolling and poor, H. & M. Oak
" 13	Land wet prairie	" 33	Land &c Same
" 12	Land level 3 rd rate timber Oak no timber U. G.	" 32	Land level mostly good soil, almost prairie, Br. & G. Oak and Hickory scarce &c
" 1	Same	" 31	Land lanous, similar, prairie level, good soil
35, 36	Land 3 rd rate, wet barrens, scattering trees M. & B. Oak		
25, 36	Land 2 nd rate, dry barrens, scattering trees M. & B. Oak & Hickory &c		
25, 26	Land wet barrens flag & butternut, timber Hickory & Oak		
24, 25	Land level wet barrens last quality and almost destitute of timber of any kind		
23, 24	Land level without timber, butternut & flag swamps		
13, 24	The whole of this line runs through open wet barrens, grass of Hickory Oak &c		
13, 14	Land generally wet barrens, a few trees B. & M. Oak		
12, 13	Land wet barrens destitute of timber, U. G. flag & butternut		
11, 12	Land level wet barrens, scattering grass trees, M. & B. Oak		
1, 12	Land level wet barrens, scarce of timber, butternut & flag swamps		
1, 2	Land level 3 rd rate, M. & B. Oak & U. G. Same swamps in places		
34, 35	Land level 3 rd rate, M. & B. Oak &c		
26, 35	The whole of this line runs through wet barrens 2 nd rate land, scarce of timber, M. & B. Oak &c		
26, 27	Land 2 nd rate, wet barrens, timber B. & M. Oak &c		
23, 26	Land mostly wet 3 rd rate, scarce of timber, a few B. & M. Oak & Hickory &c		
22, 23	Land 2 nd rate barrens, thin timber M. & B. Oak, Hickory &c		
14, 23	The whole of this line runs through an open barrens, no timber, partly flag swamps		
14, 15	Land 3 rd rate, wet, scarce of timber B. & M. Oak, U. G. &c		
11, 14	Land level, wet barrens, 3 rd rate, scarce of timber B. & M. Oak, Hickory &c		
10, 11	Land level, 3 rd rate, barrens, scarce of timber B. & M. Oak &c		
2, 11	Land level, more than 1/2 of this line runs through flag & butternut swamps, timber B. Oak &c		
2, 3	Land mostly wet, part butternut swamp, timber B. & M. Oak, U. G. &c		
33, 34	Land level 2 nd rate, scarce of timber B. & M. Oak, Hickory &c		
27, 34	Land level dry barrens, timber B. & M. Oak, Hickory &c		
27, 28	Land level dry barrens, timber B. & M. Oak		
22, 27	Land level, wet barrens, more flag & butternut swamps, timber B. & M. Oak &c		
21, 22	Land dry barrens, timber M. & B. Oak &c		
15, 22	Same		
15, 16	Land wet barrens, more flag & butternut swamps, timber B. & M. Oak		
10, 15	Land level, dry barrens, timber B. & M. Oak		
9, 10	Land level, dry barrens, timber B. & M. Oak		
3, 10	Same		
3, 4	Land greater part wet barrens, M. & B. Oak		
32, 33	Land level, wet barrens, timber Hickory, B. & M. Oak		
28, 33	Land level 2 nd rate, dry barrens, scarce of timber B. & M. Oak &c		
28, 29	Land level, mostly wet barrens B. & M. Oak, Hickory &c		
21, 28	Land level, grass of Hickory, B. & M. Oak		
20, 21	Land 3 rd rate part wet and part dry barrens, scattering B. & M. Oak &c		
16, 21	The whole of this line runs through open barrens, small groves of M. & B. Oak &c		
16, 17	Land level, wet barrens, a few trees		
9, 16	Land level dry & timberless, M. & B. Oak, no timber &c		
8, 9	Land level, mostly wet barrens, scarce of timber, M. & B. Oak &c		
4, 9	Land level and wet, scarce of timber &c		
4, 5	Land wet barrens, a few trees of B. & M. Oak &c		
31, 32	Land 3 rd rate barrens, scarce of timber Hickory, B. & M. Oak &c		
29, 32	Land level interspersed with flag and butternut swamps, scarce of timber B. & M. Oak &c		
30, 31	Land 2 nd rate scarce of timber Hickory, M. & B. Oak &c		
29, 30	Land 2 nd rate, M. & B. Oak, Elm &c		
20, 29	Land 2 nd rate, U. G. Oak, Hickory &c		
19, 30	Land level 3 rd rate, U. G. Oak &c		
19, 20	Land level 3 rd rate, U. G. Oak, Hickory &c		
17, 20	Land 3 rd rate, barrens, scattering trees B. & M. Oak &c		
18, 19	Land 3 rd rate, part wet barrens & part timbered B. & M. Oak, Spruce, Sycamore &c		
17, 18	Land level 2 nd rate, barrens, scarce of timber M. & B. Oak &c		
8, 17	Land level 3 rd rate & wet almost destitute of trees, flag & butternut swamps in places		
7, 18	Land 3 rd level and timbered with M. & B. Oak, Hickory &c		
7, 8	Land level 3 rd rate, scarce of timber of any kind and mostly wet		
5, 8	Land mostly wet barrens a few trees B. & M. Oak &c		
6, 7	Land 2 nd rate, timber M. & B. Oak, Hickory &c		
5, 6	Land 2 nd rate, barrens, scarce of timber, M. & B. Oak, Hickory &c		

Corners on Sippewannac River				
Posts.	Bearing Trees.	Inches diam'r.	Courses they bear.	Links distant
1	B. Oak	17	N. 88 E.	74
	M. Oak	15	S. 29 W.	103
2	B. Oak	9	Corner	
3	B. Oak	16	S. 32 W.	158
	M. Oak	17	N. 61 E.	131
4	M. Oak	16	S. 3 E.	330
	Ditto	18	S. 19 E.	346
5	Hickory	12	S. 29 E.	50
	B. Oak	12	N. 58 W.	47
6	B. Oak	6	N. 84 E.	15
	Ditto	4	S. 17 E.	11
7	P. Oak	9	N. 48 E.	200
	Sycamore	18	S. 33 W.	53
8	Spruce	12	S. 78 W.	48
	Hickory	6	S. 34 E.	18
9	Sycamore	14	Corner	
10	B. Oak	17	S. 87 E.	81
	Ditto	16	S. 71 W.	68
11	B. Oak	20	N. 82 E.	20
	Ditto		S. 25 E.	22
12	M. Oak	20	S. 64 E.	91
	Ditto	20	S. 46 E.	103
13	B. Oak	30	N. 4 E.	48
	M. Oak	10	S. 21 E.	120
14	M. Oak	40	S. 57 W.	140
	Ditto	35	N. 85 W.	143
15	M. Oak	26	N. 79 W.	232
	Ditto	36	N. 9 E.	403
16	M. Oak	16	Corner	
17	Sycamore	36	S. 27 E.	236
	Ditto	30	N. 45 W.	34
18	M. Oak	12	S. 40 W.	66
	Ditto	16	N. 61 E.	27
19				
20				
21				
22				
23				
24				
25				
26				
27				
28				
29				
30				
31				
32				
33				
34				
35				
36				
37				

The figures in this column refer to the Posts numbered in red ink on the Plans.

Exterior Section and Quarter Section Corners Described.

Interior Quarter Section Corners Described.

Table with columns: Posts, Bearing Trees, Inches diam'r., Courses they bear., Links distant. Rows A through U.

Table with columns: Qr. Sec. Posts on the Lines, Bearing Trees, Inches diam'r., Courses they bear., Links distant. Rows M to U at 1, P to E at 1, Q to D at 1, R to C at 1, S to B at 1, O to F at 1.

Interior Section Corners Described.

Table with columns: Corners of Sections, Bearing Trees, Inches diam'r., Courses they bear., Links distant. Rows 25, 26, 35, 36, 23, 24, 25, 26, 13, 14, 23, 24, 11, 12, 13, 14, 1, 2, 11, 12, 26, 27, 34, 35, 22, 23, 26, 27, 14, 15, 22, 23, 10, 11, 14, 15, 2, 3, 10, 11, 27, 28, 33, 34, 21, 22, 27, 28, 15, 16, 21, 22, 9, 10, 15, 16, 3, 4, 9, 10, 28, 29, 32, 33, 20, 21, 28, 29, 16, 17, 20, 21, 8, 9, 16, 17, 4, 5, 8, 9, 29, 30, 31, 32, 19, 20, 29, 30, 17, 18, 19, 20, 7, 8, 17, 18, 5, 6, 7, 8.

Table with columns: Posts, Bearing Trees, Inches diam'r., Courses they bear., Links distant. Rows A through U.

Table with columns: Qr. Sec. Posts on the Lines, Bearing Trees, Inches diam'r., Courses they bear., Links distant. Rows M to U at 1, P to E at 1, Q to D at 1, R to C at 1, S to B at 1, O to F at 1.

Township N^o 30 N. Range N^o 1 W. 2nd Mer.

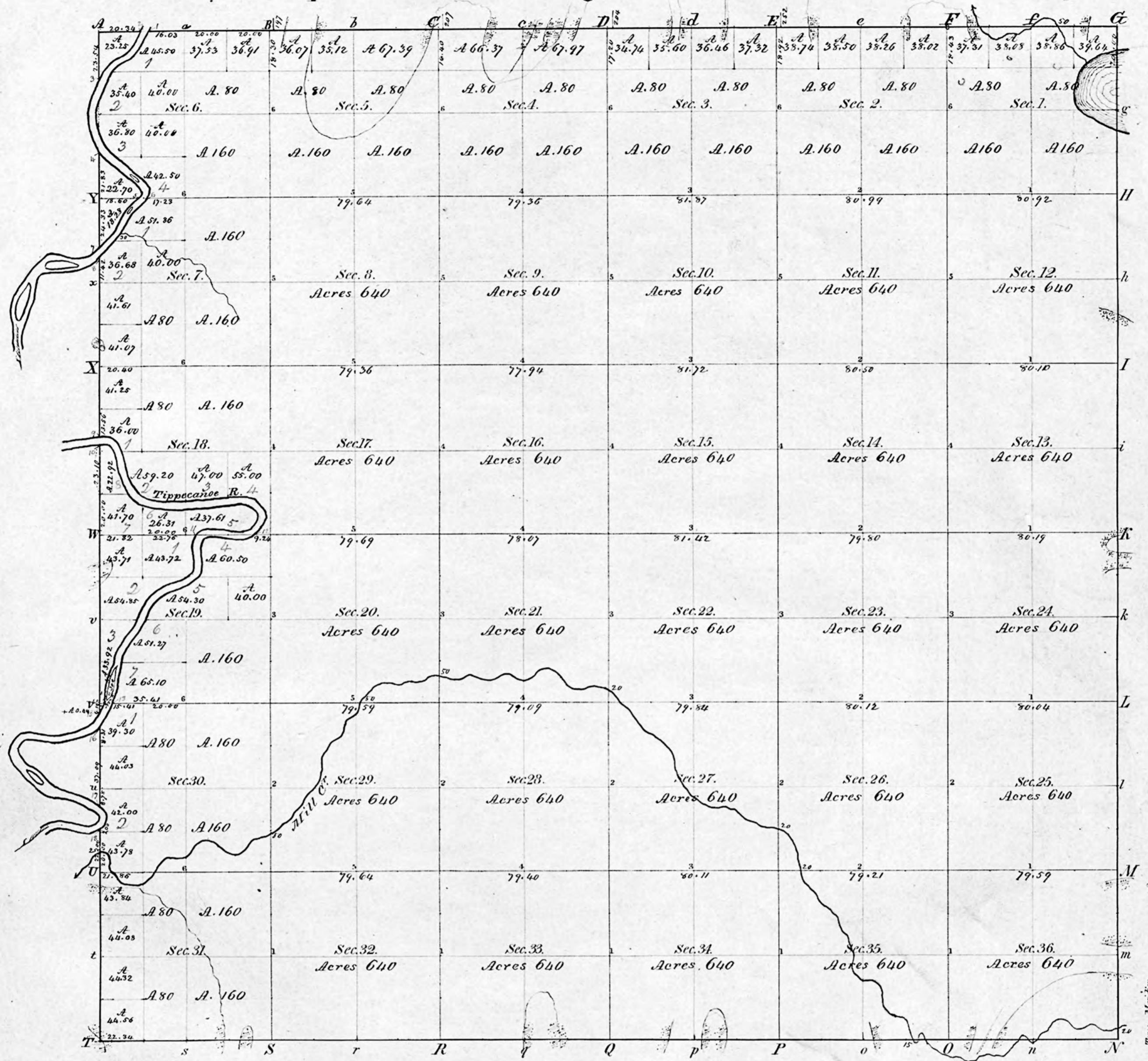

Surveyed in 1834 by Robert Hanna, Deputy Surveyor.

I certify that the above is a true copy of the Original plot in this Office.
 Surveyor General's Office.
 Detroit Nov. 1. 1847
 Lucius Lyon
 Sur. Genl.