

Quality of the Soil, Timber, &c. on the Township Lines.
East Boundary.

Sec. 36	Land gently rolling barren, few red, thinly timbered with Oak
" 25	Land so similar, well timbered, mostly by Oak some W. Oak
" 24	Except South 300 and North 230 chains Land level sandy plain, by Oak some W. Oak Br. Oak & Hickory
" 13	All river bottom, on N. bank prairie, on S. heavy timbered
" 12	South 1230 and North 130 chains level barren, remainder heavy timbered better mostly dry, as rich, etc.
" 1	Level prairie barren, very thinly timbered W. & by Oak, broken by low places

South Boundary.

Sec. 36	Land level 2 nd rate, by W. Oak
" 35	Much wet prairie, with some scattering red 2 nd rate
" 34	Land so same
" 33	Land so same
" 32	Land so same
" 31	Land so same

Description of the Land, Timber, &c. on the Interior Sectional Lines.

35, 36	Barrens 3 rd rate W. & B. Oak, prairie 2 nd rate, red top grass
25, 36	Barrens and grass, level 2 nd rate, water from 4 to 10 inches deep, W. & B. Oak prairie 2 nd rate
25, 26	Barrens same, timber same, prairie same
24, 25	
23, 24	Barrens rolling 3 rd rate W. & B. Oak, prairie second rate red top
13, 24	Barrens open level 2 nd rate, W. & B. Oak, prairie wet 2 nd rate, Marsh prairie 3 rd rate
13, 14	First 40 chains gently rolling, last 40 chains level 3 rd rate, timber as before, wet prairie 2 nd rate
12, 13	Barrens timber and Marsh prairie same, East of river rich bottom land, Oak, Ash, Elm, Walnut &c.
11, 12	Barrens level 2 nd rate timber W. & B. Oak, wet prairie 2 nd rate, Marsh prairie 3 rd rate
1, 12	Barrens same, timber same, Marsh prairie 3 rd rate
1, 2	Land gently rolling 3 rd rate, timber same, marsh prairie same, wet prairie 2 nd rate
34, 35	Barrens level 2 nd rate, W. & B. Oak, dry prairie 2 nd rate, Marsh prairie 3 rd rate
26, 35	Barrens open level sandy, red 2 nd rate, Marsh prairie 3 rd rate, red top grass
26, 27	Barrens level 2 nd rate, W. & B. Oak, wet prairie 2 nd rate red top
23, 26	Barrens gently rolling 3 rd rate, timber same, prairie 2 nd rate
22, 23	Land level 3 rd rate, W. & B. Oak, Undergrowth Whortleberry, hush and high red top grass
14, 23	Barrens level 2 nd rate, W. & B. Oak, Undergrowth Oak & Buckelony, wet prairie 2 nd rate
14, 15	Barrens low level 3 rd rate, Undergrowth Oak, Buckelony & Cottonwood bushes, Grape vines
11, 14	Barrens same, W. & B. Oak, Undergrowth same, Marsh prairie 3 rd rate
10, 11	Barrens wet 2 nd rate, timber same, Undergrowth same, prairie same
2, 11	Barrens rolling 3 rd rate, W. & B. Oak, prairie 3 rd rate high red top & Whortleberry
2, 3	Barrens level open wet 3 rd rate, W. & B. Oak, Undergrowth Oak & Buckelony bushes, Grape vines
33, 34	Grass 3 rd rate, W. & B. Oak, prairie marshy, fine red top grass, thin red
27, 34	Barrens and grass rolling 3 rd rate, W. & B. Oak, prairie marshy, red top grass
27, 28	First 70 chains barren, rolling 3 rd rate, last 10.00 level wet 2 nd rate, W. & B. Oak, Undergrowth Oak &c.
22, 27	Barrens open level, first 40 chains 2 nd rate, last 3 rd rate, timber W. & B. Oak, marsh prairie 3 rd rate
21, 22	Barrens gently rolling 3 rd rate, timber W. & B. Oak, prairie 2 nd rate
15, 22	Barrens first 66 chains rolling, last 14.00 chains level open wet all 3 rd rate, Undergrowth Oak bushes & vines
15, 16	Barrens gently rolling 3 rd rate, W. & B. Oak, prairie level 2 nd rate
10, 15	Barrens open wet 3 rd rate, W. & B. Oak, Undergrowth Oak bushes, prairie 3 rd rate
9, 10	Barrens same, W. & B. Oak, Undergrowth Oak & Buckelony bushes, dry prairie 2 nd rate, marsh 3 rd rate
3, 10	Barrens open level 3 rd rate, W. & B. Oak, Undergrowth same, Marsh 3 rd rate
3, 4	Barrens gently rolling 3 rd rate, W. & B. Oak, dry prairie 2 nd rate, marsh 3 rd rate
32, 33	Barrens gently rolling 3 rd rate, W. & B. Oak, wet prairie 2 nd rate
28, 33	Barrens sand, W. & B. Oak, grass 3 rd rate, Undergrowth Buckelony & Sassafras, Marsh prairie
28, 29	Barrens and grass open, level 3 rd rate, W. & B. Oak, Marsh prairie 3 rd rate
21, 28	Barrens first 61 chains rolling, last 19.00 open wet all 3 rd rate, W. & B. Oak, Marsh prairie 3 rd rate
20, 21	Grass 3 rd rate, W. & B. Oak, Marsh prairie 3 rd rate
16, 21	Barrens level 3 rd rate, W. & B. Oak, wet prairie 2 nd rate
16, 17	Barrens level 3 rd rate, W. & B. Oak, prairie 2 nd rate
9, 16	Barrens same, wet and dry prairie 2 nd rate, Marsh prairie 3 rd rate
8, 9	Barrens and grass same, W. & B. Oak & Aspen, wet prairie 2 nd rate
4, 9	Barrens and grass same, W. & B. Oak, prairie 3 rd rate
4, 5	Barrens same, W. & B. Oak, wet prairie 2 nd rate, Marsh 3 rd rate
31, 32	Barrens first 14.00 rolling, balance open level 3 rd rate, W. & B. Oak, wet prairie 2 nd rate
29, 32	First 66 chains open level, wet, last 19 gently rolling all 3 rd rate, W. & B. Oak, wet prairie 2 nd rate
30, 31	Barrens principally level open & 2 nd rate, Marsh prairie 3 rd rate
29, 30	Barrens first 74.00 level, last 6.00 rolling, all 3 rd rate, W. & B. Oak, prairie 2 nd rate
20, 29	Barrens and grass wet and level 3 rd rate, Undergrowth Oak, Buckelony, Hazle & Quaking Asp
19, 30	First 10.00 & last 14.00 chains barren, gently rolling, balance open level 3 rd rate, prairie 2 nd rate
19, 20	Barrens first 40 chains principally level open wet, last 4.00 rolling, all 3 rd rate
17, 20	Land in barrens & grass gently rolling 3 rd rate, timber W. & B. Oak, prairie 3 rd rate
18, 19	Land in barrens principally level 3 rd rate, W. & B. Oak, Undergrowth Oak, Quaking Asp &c.
17, 18	Barrens level 3 rd rate, W. & B. Oak, wet prairie 2 nd rate, Marsh prairie floating red
8, 17	Barrens open level 3 rd rate, W. & B. Oak, dry prairie 2 nd rate, Marsh prairie floating red
7, 18	Barrens gently rolling 3 rd rate, W. & B. Oak, prairie prairie and marshy
7, 8	Barrens level 3 rd rate, W. & B. Oak & Quaking Asp, Undergrowth Oak &c., first 22.00 chain Marsh prairie
5, 8	Barrens same, W. & B. Oak, prairie mostly thin rotten red
6, 7	Barrens first 35 chains open and level, last 4.5 level and wet, Undergrowth Quaking Asp &c.
5, 6	Barrens same as first part 6.7, Marsh prairie 3 rd rate

Corners on
Yippewana River

Posts.	Bearing Trees.	Inches diam'r.	Courses they bear.	Links distant
1	N. Ash	15	S. 72° W.	.44
	Giltie	16	S. 135° E.	.71
2	B. Walnut	24	S. 60° E.	.13
	Sp. Oak	12	S. 72° W.	.13
3	W. Oak	15	S. 10° W.	.51
	Sp. Oak	15	S. 4° E.	1.21
4	Sp. Oak	20	S. 54° W.	2.24
	B. Oak	15	S. 20° E.	1.50
5	Elm	24	S. 60° E.	.19
	Hackberry	8	S. 53° E.	.23
6	Sycamore	20	S. 9° W.	3.00
	W. Oak	30	S. 27° W.	5.53
7	Sp. Oak	7	S. 116° W.	.12
	Sycam	8	S. 235° E.	.24
8	Willow	9	S. 5° W.	.32
	Giltie	6	S. 61° E.	.23
9	Sycamore	29	S. 29° E.	2.47
	Br. Oak	24	S. 47° W.	4.19
10	Elm	16	S. 77° W.	.28
	Blue Birch	8	S. 58° E.	.3
11	W. Oak	14	S. 71° W.	.50
	Sugar	20	S. 225° E.	.70
12	Willow	8	S. 33° E.	3.22
	(No other tree)			
13	Sycamore	30	S. 43° W.	1.33
	Sp. Oak	30	S. 67° E.	.51
14				
15				
16				
17				
18				
19				
20				
21				
22				
23				
24				
25				
26				
27				
28				
29				
30				
31				
32				
33				
34				
35				
36				
37				

The figures in this column refer to the Posts numbered in red ink on the Plate.

Exterior Section and Quarter Section Corners Described.

Interior Quarter Section Corners Described.

Exterior Section and Quarter Section Corners Described.					Interior Quarter Section Corners Described.				
Posts.	Bearing Trees.	Inches diam'r.	Courses they bear.	Links distant.	Posts.	Bearing Trees.	Inches diam'r.	Courses they bear.	Links distant.
A	N. Oak	18	S. 1 E.	13.36	u	N. Oak	10	S. 4 N.	11.73
a	(No other)				v	B. Oak	12	S. 30 E.	23
B	Quaking Asp.	12	S. 42 E.	52	w	Ditto	18	S. 72 E.	11
b	B. Oak	6	S. 62 N.	2.30	x	N. Oak	15	S. 57 N.	21.6
C	B. Oak	20	S. 46 E.	2.26	y	Ditto	7	S. 57 N.	2.15
c	Ditto	12	S. 40 N.	1.26	z	B. Oak	20	S. 63 E.	42
D	N. Oak	18	S. 31 N.	7.09	aa	Ditto	18	S. 9 E.	1.6
d	Ditto	12	S. 3 E.	6.71	ab	N. Oak	18	S. 72 N.	3.55
E	B. Oak	5	S. 82 N.	3.14	ac	Ditto	16	S. 51 N.	4.24
e	N. Oak	10	S. 55 N.	2.54	ad	N. Oak	24	S. 54 N.	5.00
F	B. Oak	8	S. 48 E.	1.09	ae	N. Oak	15	S. 86 N.	5.14
f	N. Oak	12	S. 14 N.	1.09	af	Ditto	20	S. 76 N.	3.77
G	N. Oak	14	S. 72 N.	23	ag	N. Oak	20	S. 52 E.	1.23
g	Ditto	15	S. 59 E.	34	ah	B. Oak	8	S. 51 E.	1.55
h	N. Oak	12	S. 62 N.	6.31	ai	N. Oak	12	S. 75 N.	4.8
i	Ditto	16	S. 82 N.	3.95	aj	N. Oak	12	S. 75 N.	4.8
j	N. Oak	15	S. 17 N.	53	ak	N. Oak	12	S. 75 N.	4.8
k	Hickory	14	S. 54 N.	18	al	N. Oak	12	S. 75 N.	4.8
l	Sp. Oak	16	S. 35 N.	70	am	N. Oak	12	S. 75 N.	4.8
m	Maple	16	S. 34 N.	50	an	N. Oak	12	S. 75 N.	4.8
n	Sp. Oak	16	S. 12 N.	59	ao	N. Oak	12	S. 75 N.	4.8
o	N. Oak	14	S. 1 N.	91	ap	N. Oak	12	S. 75 N.	4.8
p	Doubt (Maple)	20	Corner		aq	N. Oak	12	S. 75 N.	4.8
q	Hickory	14	S. 78 N.	4.56	ar	N. Oak	12	S. 75 N.	4.8
r	N. Oak	16	S. 7 N.	4.45	as	N. Oak	12	S. 75 N.	4.8
s	N. Oak	16	S. 20 N.	14	at	N. Oak	12	S. 75 N.	4.8
t	Hickory	14	S. 62 N.	41	au	N. Oak	12	S. 75 N.	4.8
u	N. Oak	16	S. 53 N.	59	av	N. Oak	12	S. 75 N.	4.8
v	Ditto	15	S. 76 N.	64	aw	N. Oak	12	S. 75 N.	4.8
w	N. Oak	14	S. 86 N.	54	ax	N. Oak	12	S. 75 N.	4.8
x	Ditto	17	S. 40 N.	29	ay	N. Oak	12	S. 75 N.	4.8
y	N. Oak	17	S. 74 N.	2.55	az	N. Oak	12	S. 75 N.	4.8
z	N. Oak	19	S. 37 N.	2.65	ba	N. Oak	12	S. 75 N.	4.8
aa	N. Oak	16	S. 5 N.	1.19	bb	N. Oak	12	S. 75 N.	4.8
ab	Ditto	16	S. 43 N.	34	bc	N. Oak	12	S. 75 N.	4.8
ac	N. Oak	14	S. 12 N.	59	bd	N. Oak	12	S. 75 N.	4.8
ad	Ditto	9	S. 31 N.	53	be	N. Oak	12	S. 75 N.	4.8
ae	N. Oak	10	S. 74 E.	3.42	bf	N. Oak	12	S. 75 N.	4.8
af	N. Oak	6	S. 59 N.	4.57	bg	N. Oak	12	S. 75 N.	4.8
ag	N. Oak	12	S. 55 N.	60	bh	N. Oak	12	S. 75 N.	4.8
ah	Ditto	10	S. 13 N.	5.01	bi	N. Oak	12	S. 75 N.	4.8
ai	N. Oak	12	S. 35 N.	2.40	bj	N. Oak	12	S. 75 N.	4.8
aj	N. Oak	12	S. 16 E.	2.79	bk	N. Oak	12	S. 75 N.	4.8
ak	N. Oak	12	S. 44 E.	2.46	bl	N. Oak	12	S. 75 N.	4.8
al	Ditto	6	S. 1 E.	2.15	bm	N. Oak	12	S. 75 N.	4.8
am	Pat in water too deep for mound				bn	N. Oak	12	S. 75 N.	4.8
an	N. Oak	9	S. 69 E.	5.97	bo	N. Oak	12	S. 75 N.	4.8
ao	(No other near)				bp	N. Oak	12	S. 75 N.	4.8
ap	N. Oak	6	East	6.90	bq	N. Oak	12	S. 75 N.	4.8
aq	(No other near)				br	N. Oak	12	S. 75 N.	4.8
ar	N. Oak	10	S. 22 E.	51	bs	N. Oak	12	S. 75 N.	4.8
as	Ditto	8	S. 54 E.	1.57	bt	N. Oak	12	S. 75 N.	4.8
at	N. Oak	6	S. 57 E.	45	bu	N. Oak	12	S. 75 N.	4.8
au	N. Oak	14	S. 16 N.	35	bv	N. Oak	12	S. 75 N.	4.8
av	N. Oak	8	S. 59 N.	53	bv	N. Oak	12	S. 75 N.	4.8
aw	N. Oak	10	S. 17 E.	63	bw	N. Oak	12	S. 75 N.	4.8
ax	N. Oak	10	S. 7 N.	3.59	bx	N. Oak	12	S. 75 N.	4.8
ay	Ditto	12	S. 52 N.	3.42	bx	N. Oak	12	S. 75 N.	4.8
az	N. Oak	10	S. 46 E.	1.51	bx	N. Oak	12	S. 75 N.	4.8
ba	Ditto	12	S. 52 N.	1.56	bx	N. Oak	12	S. 75 N.	4.8
bb	Aspen	6	S. 10 N.	14.25	bx	N. Oak	12	S. 75 N.	4.8
bc	(No other)				bx	N. Oak	12	S. 75 N.	4.8
bd	Pat in water too deep for mound				bx	N. Oak	12	S. 75 N.	4.8
be	Pat in water too deep for mound				bx	N. Oak	12	S. 75 N.	4.8
bf	Pat in water too deep for mound				bx	N. Oak	12	S. 75 N.	4.8
bg	Pat in water too deep for mound				bx	N. Oak	12	S. 75 N.	4.8
bh	Pat in water too deep for mound				bx	N. Oak	12	S. 75 N.	4.8
bi	Pat in water too deep for mound				bx	N. Oak	12	S. 75 N.	4.8
bj	Pat in water too deep for mound				bx	N. Oak	12	S. 75 N.	4.8
bk	Pat in water too deep for mound				bx	N. Oak	12	S. 75 N.	4.8
bl	Pat in water too deep for mound				bx	N. Oak	12	S. 75 N.	4.8
bm	Pat in water too deep for mound				bx	N. Oak	12	S. 75 N.	4.8
bn	Pat in water too deep for mound				bx	N. Oak	12	S. 75 N.	4.8
bo	Pat in water too deep for mound				bx	N. Oak	12	S. 75 N.	4.8
bp	Pat in water too deep for mound				bx	N. Oak	12	S. 75 N.	4.8
bq	Pat in water too deep for mound				bx	N. Oak	12	S. 75 N.	4.8
br	Pat in water too deep for mound				bx	N. Oak	12	S. 75 N.	4.8
bs	Pat in water too deep for mound				bx	N. Oak	12	S. 75 N.	4.8
bt	Pat in water too deep for mound				bx	N. Oak	12	S. 75 N.	4.8
bu	Pat in water too deep for mound				bx	N. Oak	12	S. 75 N.	4.8
bv	Pat in water too deep for mound				bx	N. Oak	12	S. 75 N.	4.8
bw	Pat in water too deep for mound				bx	N. Oak	12	S. 75 N.	4.8
bx	Pat in water too deep for mound				bx	N. Oak	12	S. 75 N.	4.8
by	Pat in water too deep for mound				bx	N. Oak	12	S. 75 N.	4.8
bz	Pat in water too deep for mound				bx	N. Oak	12	S. 75 N.	4.8
ca	Pat in water too deep for mound				bx	N. Oak	12	S. 75 N.	4.8
cb	Pat in water too deep for mound				bx	N. Oak	12	S. 75 N.	4.8
cc	Pat in water too deep for mound				bx	N. Oak	12	S. 75 N.	4.8
cd	Pat in water too deep for mound				bx	N. Oak	12	S. 75 N.	4.8
ce	Pat in water too deep for mound				bx	N. Oak	12	S. 75 N.	4.8
cf	Pat in water too deep for mound				bx	N. Oak	12	S. 75 N.	4.8
cg	Pat in water too deep for mound				bx	N. Oak	12	S. 75 N.	4.8
ch	Pat in water too deep for mound				bx	N. Oak	12	S. 75 N.	4.8
ci	Pat in water too deep for mound				bx	N. Oak	12	S. 75 N.	4.8
cj	Pat in water too deep for mound				bx	N. Oak	12	S. 75 N.	4.8
ck	Pat in water too deep for mound				bx	N. Oak	12	S. 75 N.	4.8
cl	Pat in water too deep for mound				bx	N. Oak	12	S. 75 N.	4.8
cm	Pat in water too deep for mound				bx	N. Oak	12	S. 75 N.	4.8
cn	Pat in water too deep for mound				bx	N. Oak	12	S. 75 N.	4.8
co	Pat in water too deep for mound				bx	N. Oak	12	S. 75 N.	4.8
cp	Pat in water too deep for mound				bx	N. Oak	12	S. 75 N.	4.8
cq	Pat in water too deep for mound				bx	N. Oak	12	S. 75 N.	4.8
cr	Pat in water too deep for mound				bx	N. Oak	12	S. 75 N.	4.8
cs	Pat in water too deep for mound				bx	N. Oak	12	S. 75 N.	4.8
ct	Pat in water too deep for mound				bx	N. Oak	12	S. 75 N.	4.8
cu	Pat in water too deep for mound				bx	N. Oak	12	S. 75 N.	4.8
cv	Pat in water too deep for mound				bx	N. Oak	12	S. 75 N.	4.8
cw	Pat in water too deep for mound				bx	N. Oak	12	S. 75 N.	4.8
cx	Pat in water too deep for mound				bx	N. Oak	12	S. 75 N.	4.8
cy	Pat in water too deep for mound				bx	N. Oak	12	S. 75 N.	4.8
cz	Pat in water too deep for mound				bx	N. Oak	12	S. 75 N.	4.8
da	Pat in water too deep for mound				bx	N. Oak	12	S. 75 N.	4.8
db	Pat in water too deep for mound				bx	N. Oak	12	S. 75 N.	4.8
dc	Pat in water too deep for mound				bx	N. Oak	12	S. 75 N.	4.8
dd	Pat in water too deep for mound				bx	N. Oak	12	S. 75 N.	4.8
de	Pat in water too deep for mound				bx	N. Oak	12	S. 75 N.	4.8
df	Pat in water too deep for mound				bx	N. Oak	12	S. 75 N.	4.8
dg	Pat in water too deep for mound				bx	N. Oak	12	S. 75 N.	4.8
dh	Pat in water too deep for mound				bx	N. Oak	12	S. 75 N.	4.8
di	Pat in water too deep for mound				bx	N. Oak	12	S. 75 N.	4.8
dj	Pat in water too deep for mound				bx	N. Oak	12	S. 75 N.	4.8
dk	Pat in water too deep for mound				bx	N. Oak	12	S. 75 N.	4.8
dl	Pat in water too deep for mound				bx	N. Oak	12	S. 75 N.	4.8
dm	Pat in water too deep for mound				bx	N. Oak	12	S. 75 N.	4.8
dn	Pat in water too deep for mound				bx	N. Oak	12	S. 75 N.	4.8
do	Pat in water too deep for mound				bx	N. Oak	12	S. 75 N.	4.8
dp	Pat in water too deep for mound				bx	N. Oak	12	S. 75 N.	4.8
dq	Pat in water too deep for mound				bx	N. Oak	12	S. 75 N.	4.8
dr	Pat in water too deep for mound				bx	N. Oak	12	S. 75 N.	4.8
ds	Pat in water too deep for mound				bx	N. Oak	12	S. 75 N.	4.8
dt	Pat in water too deep for mound				bx	N. Oak	12	S. 75 N.	4.8
du	Pat in water too deep for mound				bx	N. Oak	12	S. 75 N.	4.8
dv	Pat in water too deep for mound				bx	N. Oak	12	S. 75 N.	4.8
dw	Pat in water too deep for mound				bx	N. Oak	12	S. 75 N.	4.8
dx	Pat in water too deep for mound				bx	N. Oak	12	S. 75 N.	4.8
dy	Pat in water too deep for mound				bx	N. Oak	12	S. 75 N.	4.8
dz	Pat in water too deep for mound				bx	N. Oak	12	S. 75 N.	4.8

Township N^o 31 N. Range N^o 2 W. 2nd Mer.

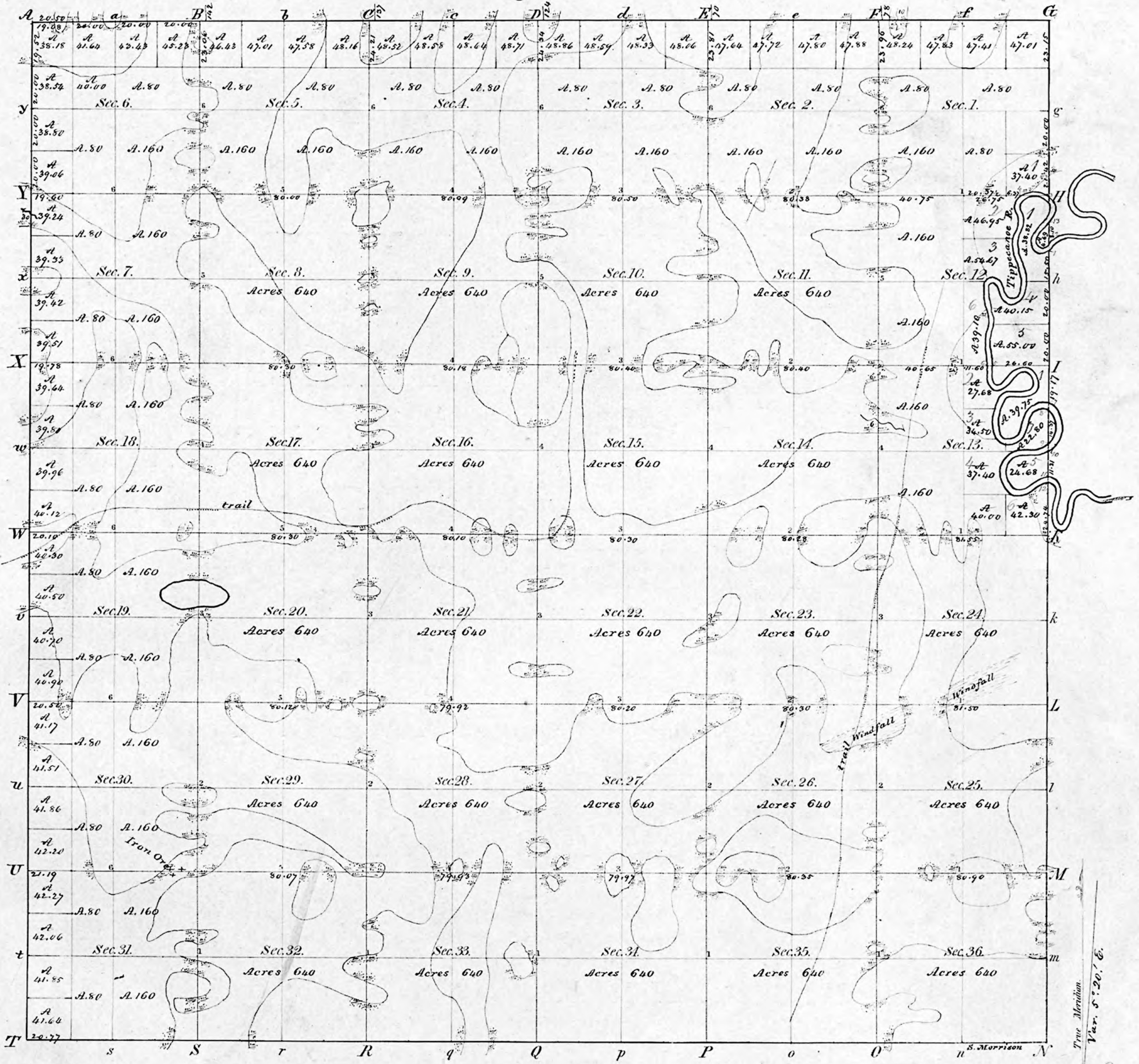

Surveyed in 1834 by Abner E. Van Ness, Deputy Surveyor.

I certify that the above is a true copy of the Original plot in this Office.
 Surveyor General's Office, Lucius Lyon,
 Detroit Nov. 1. 1849. Sur. Gen!