

Quality of the Soil, Timber, &c. on the Township Lines.

East Boundary.

South Boundary.

Description of the Land, Timber, &c. on the Interior Sectional Lines.

Sec. 36	Land level 2 <sup>nd</sup> rate, timber Oak
" 25	Land level 3 <sup>rd</sup> rate, timber Oak
" 24	Land similar
" 13	Land similar
" 12	Land and timber similar
" 1	Land so as before
Sec. 36	W. of Marsh Land level barrens with little timber Hickory & Oak
" 35	W. of prairie a 4 <sup>th</sup> Oak sandy ridge per soil prairie some parts dry enough for cultivation 2 <sup>nd</sup> rate
" 34	E. 25 rolling, per 4 <sup>th</sup> Oak barrens, W. 35.00 level mostly low, some small scattering per Oak per soil
" 33	Land similar
" 32	Some small dry some places low some stone, W. of prairie level per barrens, thin timber Oak
" 31	Rolling, barrens thin soil, W. 4 <sup>th</sup> Oak
35, 36	In barrens and grass 3 <sup>rd</sup> rate, W. 13 <sup>th</sup> Oak, prairie not 2 <sup>nd</sup> rate, Marsh per soil, fine red top
25, 36	3 <sup>rd</sup> rate barrens, W. 13 <sup>th</sup> Oak, prairie 2 <sup>nd</sup> rate Marsh per soil
25, 26	Barrens sandy 3 <sup>rd</sup> rate, Oak prairie 2 <sup>nd</sup> rate Marsh per soil
24, 25	Level 1 <sup>st</sup> rate, Oak, Elm, Hickory, Ash
23, 24	Barrens 3 <sup>rd</sup> rate, W. Oak, prairie 2 <sup>nd</sup> rate level
13, 24	1 <sup>st</sup> half level, East rolling, barrens 3 <sup>rd</sup> rate, prairie 2 <sup>nd</sup> rate, W. 13 <sup>th</sup> Oak
13, 14	Barrens 3 <sup>rd</sup> rate prairie 2 <sup>nd</sup> rate Black & W. Oak
12, 13	Barrens 3 <sup>rd</sup> rate prairie marshy, 3 <sup>rd</sup> rate timber same
11, 12	Level 2 <sup>nd</sup> rate, timber Bar, B. W. Oak, W. Irish Oak bushes
1, 12	Just 31 chs level barrens 2 <sup>nd</sup> rate, timber Bar B. W. Oak prairie 3 <sup>rd</sup> rate, barrens on E. end 3 <sup>rd</sup> rate
1, 2	Level 2 <sup>nd</sup> rate in barrens, timber S. of river B. W. Oak, Hickory, S. of river Elm, Sycamore &c.
34, 35	Barrens rolling 3 <sup>rd</sup> rate, prairie 2 <sup>nd</sup> rate
26, 35	Barrens rolling 3 <sup>rd</sup> rate, W. prairie 2 <sup>nd</sup> rate, E. & P. in prairie 3 <sup>rd</sup> rate, W. 13 <sup>th</sup> Oak
26, 27	Barrens rolling, sandy 3 <sup>rd</sup> rate, B. W. Oak prairie 2 <sup>nd</sup> rate
23, 26	Barrens gently rolling, sandy 3 <sup>rd</sup> rate, B. W. Oak, Cranberry Marsh 3 <sup>rd</sup> rate
22, 23	Barrens 3 <sup>rd</sup> rate gently rolling, B. W. Oak prairie 2 <sup>nd</sup> rate
14, 23	Barrens same, B. W. Oak prairie 2 <sup>nd</sup> rate
14, 15	Prairie 2 <sup>nd</sup> rate, Cranberry Marsh 3 <sup>rd</sup> rate
11, 14	Barrens level 2 <sup>nd</sup> rate W. 13 <sup>th</sup> Oak, prairie 2 <sup>nd</sup> rate, red top grass
10, 11	Barrens same heavy timber W. 13 <sup>th</sup> Oak, prairie second rate, grass same
2, 11	Barrens same, W. 13 <sup>th</sup> Oak, prairie second rate
2, 3	Barrens same, W. 13 <sup>th</sup> Oak, Marsh prairie 3 <sup>rd</sup> rate
33, 34	Barrens same, W. 13 <sup>th</sup> Oak, prairie second rate
27, 34	Barrens rolling 2 <sup>nd</sup> rate, B. W. Oak, prairie second rate
27, 28	Barrens same, B. W. Oak, prairie second rate
22, 27	Land in barrens, rolling 3 <sup>rd</sup> rate, B. W. Oak, prairie second rate
21, 22	Barrens same, B. W. Oak, prairie second rate
15, 22	Prairie not 2 <sup>nd</sup> rate, water from 4 to 11 inches deep, grass 2 <sup>nd</sup> rate, timber W. Oak
15, 16	Barrens rolling 2 <sup>nd</sup> rate, timber W. 13 <sup>th</sup> Oak, prairie 2 <sup>nd</sup> rate
10, 15	Barrens same, W. Oak, prairie 2 <sup>nd</sup> rate
9, 10	Barrens rolling 2 <sup>nd</sup> rate, W. 13 <sup>th</sup> Oak, prairie 3 <sup>rd</sup> rate
3, 10	Barrens level 3 <sup>rd</sup> rate, prairie 2 <sup>nd</sup> rate
3, 4	Barrens rolling 2 <sup>nd</sup> rate, W. 13 <sup>th</sup> Oak, prairie 2 <sup>nd</sup> rate
32, 33	Barrens level 2 <sup>nd</sup> rate, W. 13 <sup>th</sup> Oak, prairie 2 <sup>nd</sup> rate
28, 33	Level 2 <sup>nd</sup> rate, W. 13 <sup>th</sup> Oak, prairie level 2 <sup>nd</sup> rate, feed mill rot
28, 29	Barrens level 3 <sup>rd</sup> rate, B. W. Oak, second rate prairie
21, 28	Barrens level 2 <sup>nd</sup> rate, W. 13 <sup>th</sup> Oak, prairie 2 <sup>nd</sup> rate
20, 21	Barrens level 2 <sup>nd</sup> rate, W. 13 <sup>th</sup> Oak, prairie 2 <sup>nd</sup> rate
16, 21	Barrens rolling 3 <sup>rd</sup> rate, W. 13 <sup>th</sup> Oak, prairie same
16, 17	Just 40 chains in barrens level 2 <sup>nd</sup> rate, Bottom gently rolling, not prairie 2 <sup>nd</sup> rate
9, 16	Just 40 chains barrens rolling, barrens level 3 <sup>rd</sup> rate, Cranberry Marsh 3 <sup>rd</sup> rate W. 13 <sup>th</sup> Oak
8, 9	Barrens level 2 <sup>nd</sup> rate, W. Irish Oak bushes, prairie 2 <sup>nd</sup> rate
4, 9	Barrens level 2 <sup>nd</sup> rate, W. 13 <sup>th</sup> Oak, Hickory, W. B. Oak bushes & Sassafras, prairie 2 <sup>nd</sup> rate
4, 5	South of river level 2 <sup>nd</sup> rate, W. 13 <sup>th</sup> Oak prairie 2 <sup>nd</sup> rate, S. of river rolling 2 <sup>nd</sup> rate
31, 32	S. of river barrens, rolling 2 <sup>nd</sup> rate, B. W. Oak, S. of river level 2 <sup>nd</sup> rate, timber same
29, 32	Barrens gently rolling, 2 <sup>nd</sup> rate B. W. Oak, mottled marshy 3 <sup>rd</sup> rate
30, 31	Barrens level 2 <sup>nd</sup> rate, W. 13 <sup>th</sup> Oak, prairie 2 <sup>nd</sup> rate
29, 30	Barrens same timber same, prairie 3 <sup>rd</sup> rate
20, 29	Barrens same, timber same, scattering marsh prairie 3 <sup>rd</sup> rate, low low prairie 2 <sup>nd</sup> rate
19, 30	Barrens same, timber 2 <sup>nd</sup> rate, Bottom 1 <sup>st</sup> rate
19, 20	Barrens same, W. 13 <sup>th</sup> Oak, scattering marsh prairie 3 <sup>rd</sup> rate
17, 20	Barrens same, W. 13 <sup>th</sup> Oak, Marsh 3 <sup>rd</sup> rate, not prairie 3 <sup>rd</sup> rate
18, 19	Barrens E. & W. of river same, 3 chains on W. side of river 1 <sup>st</sup> rate, Poplar, Elm, Oak
17, 18	Barrens same, W. 13 <sup>th</sup> Oak, prairie 2 <sup>nd</sup> rate
8, 17	Barrens 1 <sup>st</sup> half level, East rolling 2 <sup>nd</sup> rate, W. 13 <sup>th</sup> Oak, Cranberry Marsh 3 <sup>rd</sup> rate
7, 18	Barrens level 2 <sup>nd</sup> rate, wet and dry prairie second rate
7, 8	Barrens same, W. 13 <sup>th</sup> Oak, prairie 2 <sup>nd</sup> rate
5, 8	Land in barrens, level 2 <sup>nd</sup> rate, W. 13 <sup>th</sup> Oak, prairie 2 <sup>nd</sup> rate
6, 7	Barrens same, timber same, prairie 3 <sup>rd</sup> rate
5, 6	Barrens and timber same, prairie 3 <sup>rd</sup> rate

Corners on  
Tipppecanee River

Posts	Bearing Trees	Inches diam'r	Courses they bear	Links distant
1	Sassafras	6	S. 45 E.	25
	Br. Oak	8	North	5
2	B. Oak	12	S. 75 E.	25
	B. Oak	6	N. 71 W.	23
3	Willow	10	N. 57 E.	22
	Willow	4	S. 77 W.	22
4	Br. Oak	12	S. 40 E.	3.66
	Willow	18	S. 7 E.	3.26
5	W. Oak	18	N. 45 E.	4.90
	Willow	18	N. 68 E.	3.57
6	B. Oak	8	S. 39 E.	47
	W. Oak	24	S. 58 W.	1.54
7	W. Oak	18	N. 25 E.	4.76
8	Br. Oak	18	S. 25 E.	1.29
	Willow	28	S. 4 E.	1.14
9	Br. Oak	19	S. 75 E.	3.12
	Maple	8	N. 19 E.	31
10	W. Oak	14	N. 17 W.	2.23
	Willow	16	N. 33 W.	1.73
11	Pat. no bearings given			
12	Sym	12	Corner	
13	Willow	5	S. 51 W.	51
	Willow	8	N. 71 W.	44
14	Maple	8	S. 61 W.	41
	Elm	15	N. 3 E.	64
15	W. Oak	15	N. 31 E.	2.05
	Willow	20	N. 27 W.	2.02
16	Pat in mound			
17	Sym	5	S. 75 W.	14
	Sycamore	12	N. 68 W.	13
18	Maple	20	N. 57 E.	70
	B. Oak	30	N. 53 W.	1.93
19	B. Oak	20	N. 5 E.	2.52
	Willow	10	S. 79 W.	3.08
20	W. Oak	12	S. 12 E.	2.44
	B. Oak	20	S. 45 E.	2.97
21	B. Oak	7	N. 31 E.	32
	W. Oak	30	S. 66 E.	37
22	Maple	20	N. 44 W.	18
	Ash	24	N. 77 W.	71
23	Maple	12	S. 35 E.	64
	Sycamore	15	N. 53 E.	40
24	Hickory	7	N. 30 W.	1.01
	Willow	10	N. 55 W.	2.09
25	W. Oak	15	N. 10 W.	91
	Y. Oak	18	N. 4 E.	1.21
26	Sycamore	30	S. 43 W.	1.35
	Y. Oak	30	N. 67 E.	58
27	B. Walnut	24	N. 60 E.	13
	Y. Oak	12	S. 73 W.	13
28	W. Oak	13	S. 42 W.	44
	Willow	16	S. 13 E.	71
29	Y. Oak	7	N. 16 W.	12
	Sym	8	N. 25 E.	24
30	Willow	9	N. 5 W.	32
	Willow	6	N. 61 E.	23
31	Sycamore	39	N. 29 E.	2.47
	Br. Oak	24	N. 47 W.	4.15
32	Elm	16	N. 77 W.	25
	Blue Birch	8	S. 30 E.	3
33	B. Oak	14	N. 71 W.	50
	Sugar	20	N. 22 E.	70
34	Willow	8	S. 33 E.	3.22
	No other trees			
35	Sycamore	20	S. 23 W.	16
	W. Oak	30	N. 60 E.	60
36	Maple	12	S. 55 W.	33
	W. Oak	30	N. 18 E.	65
37	Willow	12	S. 51 W.	40
	B. Oak	12	N. 36 W.	40

The figures in this column refer to the Posts numbered in red ink on the Plans.

Township No. 31 North, Range No. 1 West 3rd Meridian, Indiana

Exterior Section and Quarter Section Corners Described.

Interior Quarter Section Corners Described.

Main table with columns for Posts, Bearing Trees, Inches diam'r., Courses they bear., Links distant. Includes sub-sections for Interior Section Corners and Corners in Appearance River Cont'd.

Township N<sup>o</sup> 31 N. Range N<sup>o</sup> 1 W. 2<sup>nd</sup> Mer.

4.

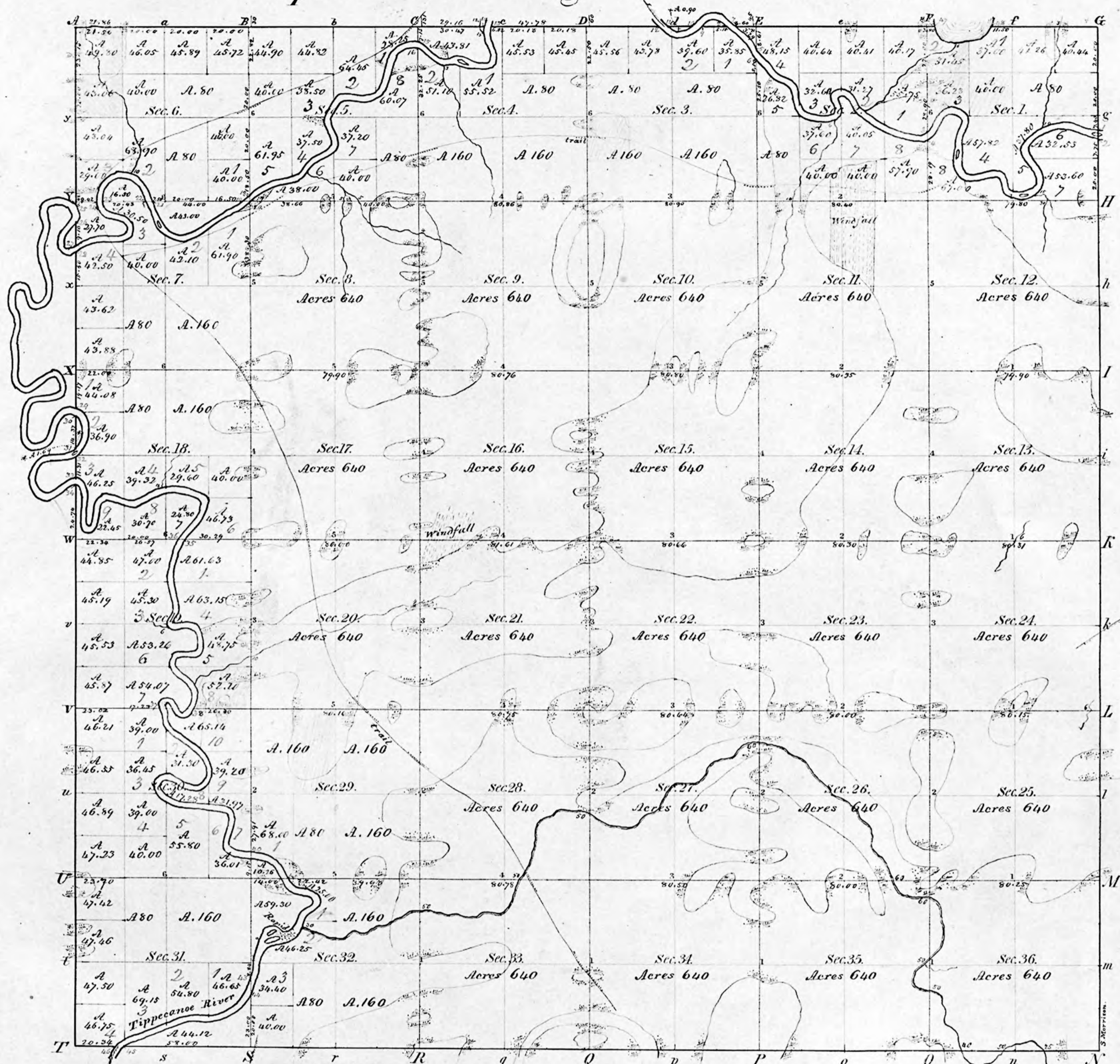

Surveyed in 1834 by Abner E. Van Ness, Deputy Surveyor.

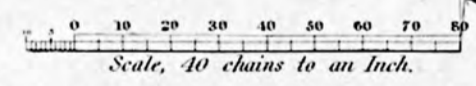

I certify that the above is a true copy of the Original plat in this Office.  
 Surveyor General's Office. Lucius Lyon,  
 Detroit Nov. 1. 1849. Sur. Gen!