

Quality of the Soil, Timber, &c. on the Township Lines			Posts.	Bearing Trees.	Inches diam'r.	Courses they bear.	Links distant	
East Boundary.	Sec. 36	Level & good. W. Y. & Br. Oak.						
	" 25	Same						
	" 24	Mostly wet prairie - scattering Oak.						
	" 13	Same						
	" 12	Same						
	" 1	Same						
	South Boundary.	Sec. 36	Gently rolling 1 st rate. Oak					
		" 35	Same					
		" 34	Low & mostly prairie - some scattering Oak.					
		" 33	Gently rolling 2 nd rate. Oak.					
		" 32	Rather level - soil poor. Oak.					
		" 31	Mostly marsh - soil poor. Oak, Aspen &c. very scattering.					
	Description of the Land, Timber, &c. on the Interior Sectional Lines.	35, 36	Level 1 st rate prairie. Grass & reed weed the principal growth					
		25, 36	Same					
		25, 26	Same					
		24, 25	Same					
23, 24		Same						
13, 24		Same						
13, 14		Same						
12, 13		Same						
11, 12		Dry prairie - some groves of B. & W. Oak.						
1, 12		Same - a few trees & flag swamp.						
1, 2		Level dry barrens - B. & W. Oak						
34, 35		Level mostly dry prairie - small groves of Oak.						
26, 35		Rolling dry prairie						
26, 27		Same - 2 nd rate.						
23, 26		Level mostly dry prairie - 2 nd rate						
22, 23		Same						
14, 23		Same						
14, 15		Same						
11, 14		Same						
10, 11		2 nd rate - part prairie & part thinly timbered with Burr, White & Black Oak.						
2, 11		Level dry barrens - B. & W. Oak.						
2, 3		Level with principally prairie.						
33, 34		2 nd rate barrens. Timber scarce - B. & W. Oak.						
27, 34		Generally wet prairie 2 nd rate.						
27, 28		Same						
22, 27		Level 1 st rate prairie						
21, 22		Level greater part wet prairie						
15, 22		Dry level prairie						
15, 16		2 nd rate prairie - U. S. Co.						
10, 15		Level 1 st rate prairie.						
9, 10		Same						
3, 10		Co. & a few trees - Br. & W. Oak - W. & 1 st rate prairie						
3, 4		1 st rate prairie.						
32, 33		Rolling barrens - B. & W. Oak - scarce.						
28, 33		Level wet barrens. Same.						
28, 29		Level wet prairie.						
21, 28		1 st rate greater part prairie - scattering Oak & Hickory &c.						
20, 21		2 nd rate prairie						
16, 21		Same						
16, 17		Same						
9, 16		Same						
8, 9		Same						
4, 9		Same						
4, 5		-						
31, 32		Level dry barrens - B. & W. Oak.						
29, 32		Generally wet prairie						
30, 31		Same - groves of W. & B. Oak						
29, 30		1 st rate dry prairie. Some groves of W. & B. Oak.						
20, 29	Rolling dry prairie 2 nd rate							
19, 30	Level wet prairie							
19, 20	Rolling dry prairie.							
17, 20	Same							
18, 19	Wet prairie							
17, 18	Level prairie. 2 nd rate.							
8, 17	Same							
7, 18	Same							
7, 8	Same							
5, 8	Level dry prairie.							
6, 7	Level - part wet & part dry prairie.							
5, 6	Level 1 st rate prairie.							

The figures in this column refer to the Posts numbered in red ink on the Plans.

Exterior Section and Quarter Section Corners Described.

Interior Quarter Section Corners Described.

Posts.	Bearing Trees.	Inches diam'r.	Courses they bear.	Links distant.
A	Post in mound			
a				
B	Post in mound			
b				
C	Post in mound			
c				
D	Post in mound			
d				
E	B. Oak 24 S 87 W 57 no other			
e				
F	W. Oak 24 S 10 W 99 W. Oak 12 S 14 E 125			
f				

Interior Section Corners Described.

Posts.	Bearing Trees.	Inches diam'r.	Courses they bear.	Links distant.
u	Aspen 9 S 3 1/2 E 877 No other			
v	U. Oak 9 N 3 E 132 W. Oak 6 N 89 1/2 E 282 U. Oak 18 North 807 U. Oak 20 N 6 1/2 E 795			
w	Post in mound			
x	Post in mound			
y	Post in mound			
z	Post in mound			
aa	Post in mound			
ab	Post in mound			
ac	Post in mound			
ad	Post in mound			
ae	Post in mound			
af	Post in mound			
ag	Post in mound			
ah	Post in mound			
ai	Post in mound			
aj	Post in mound			
ak	Post in mound			
al	Post in mound			
am	Post in mound			
an	Post in mound			
ao	Post in mound			
ap	Post in mound			
aq	Post in mound			
ar	Post in mound			
as	Post in mound			
at	Post in mound			
au	Post in mound			
av	Post in mound			
aw	Post in mound			
ax	Post in mound			
ay	Post in mound			
az	Post in mound			
ba	Post in mound			
bb	Post in mound			
bc	Post in mound			
bd	Post in mound			
be	Post in mound			
bf	Post in mound			
bg	Post in mound			
bh	Post in mound			
bi	Post in mound			
bj	Post in mound			
bk	Post in mound			
bl	Post in mound			
bm	Post in mound			
bn	Post in mound			
bo	Post in mound			
bp	Post in mound			
bq	Post in mound			
br	Post in mound			
bs	Post in mound			
bt	Post in mound			
bu	Post in mound			
bv	Post in mound			
bw	Post in mound			
bx	Post in mound			
by	Post in mound			
bz	Post in mound			
ca	Post in mound			
cb	Post in mound			
cc	Post in mound			
cd	Post in mound			
ce	Post in mound			
cf	Post in mound			
cg	Post in mound			
ch	Post in mound			
ci	Post in mound			
cj	Post in mound			
ck	Post in mound			
cl	Post in mound			
cm	Post in mound			
cn	Post in mound			
co	Post in mound			
cp	Post in mound			
cq	Post in mound			
cr	Post in mound			
cs	Post in mound			
ct	Post in mound			
cu	Post in mound			
cv	Post in mound			
cw	Post in mound			
cx	Post in mound			
cy	Post in mound			
cz	Post in mound			
da	Post in mound			
db	Post in mound			
dc	Post in mound			
dd	Post in mound			
de	Post in mound			
df	Post in mound			
dg	Post in mound			
dh	Post in mound			
di	Post in mound			
dj	Post in mound			
dk	Post in mound			
dl	Post in mound			
dm	Post in mound			
dn	Post in mound			
do	Post in mound			
dp	Post in mound			
dq	Post in mound			
dr	Post in mound			
ds	Post in mound			
dt	Post in mound			
du	Post in mound			
dv	Post in mound			
dw	Post in mound			
dx	Post in mound			
dy	Post in mound			
dz	Post in mound			
ea	Post in mound			
eb	Post in mound			
ec	Post in mound			
ed	Post in mound			
ee	Post in mound			
ef	Post in mound			
eg	Post in mound			
eh	Post in mound			
ei	Post in mound			
ej	Post in mound			
ek	Post in mound			
el	Post in mound			
em	Post in mound			
en	Post in mound			
eo	Post in mound			
ep	Post in mound			
eq	Post in mound			
er	Post in mound			
es	Post in mound			
et	Post in mound			
eu	Post in mound			
ev	Post in mound			
ew	Post in mound			
ex	Post in mound			
ey	Post in mound			
ez	Post in mound			
fa	Post in mound			
fb	Post in mound			
fc	Post in mound			
fd	Post in mound			
fe	Post in mound			
ff	Post in mound			
fg	Post in mound			
fh	Post in mound			
fi	Post in mound			
fj	Post in mound			
fk	Post in mound			
fl	Post in mound			
fm	Post in mound			
fn	Post in mound			
fo	Post in mound			
fp	Post in mound			
fq	Post in mound			
fr	Post in mound			
fs	Post in mound			
ft	Post in mound			
fu	Post in mound			
fv	Post in mound			
fw	Post in mound			
fx	Post in mound			
fy	Post in mound			
fz	Post in mound			
ga	Post in mound			
gb	Post in mound			
gc	Post in mound			
gd	Post in mound			
ge	Post in mound			
gf	Post in mound			
gg	Post in mound			
gh	Post in mound			
gi	Post in mound			
gj	Post in mound			
gk	Post in mound			
gl	Post in mound			
gm	Post in mound			
gn	Post in mound			
go	Post in mound			
gp	Post in mound			
gq	Post in mound			
gr	Post in mound			
gs	Post in mound			
gt	Post in mound			
gu	Post in mound			
gv	Post in mound			
gw	Post in mound			
gx	Post in mound			
gy	Post in mound			
gz	Post in mound			
ha	Post in mound			
hb	Post in mound			
hc	Post in mound			
hd	Post in mound			
he	Post in mound			
hf	Post in mound			
hg	Post in mound			
hh	Post in mound			
hi	Post in mound			
hj	Post in mound			
hk	Post in mound			
hl	Post in mound			
hm	Post in mound			
hn	Post in mound			
ho	Post in mound			
hp	Post in mound			
hq	Post in mound			
hr	Post in mound			
hs	Post in mound			
ht	Post in mound			
hu	Post in mound			
hv	Post in mound			
hw	Post in mound			
hx	Post in mound			
hy	Post in mound			
hz	Post in mound			
ia	Post in mound			
ib	Post in mound			
ic	Post in mound			
id	Post in mound			
ie	Post in mound			
if	Post in mound			
ig	Post in mound			
ih	Post in mound			
ii	Post in mound			
ij	Post in mound			
ik	Post in mound			
il	Post in mound			
im	Post in mound			
in	Post in mound			
io	Post in mound			
ip	Post in mound			
iq	Post in mound			
ir	Post in mound			
is	Post in mound			
it	Post in mound			
iu	Post in mound			
iv	Post in mound			
iw	Post in mound			
ix	Post in mound			
iy	Post in mound			
iz	Post in mound			
ja	Post in mound			
jb	Post in mound			
jc	Post in mound			
jd	Post in mound			
je	Post in mound			
jf	Post in mound			
jj	Post in mound			
jh	Post in mound			
ji	Post in mound			
jj	Post in mound			
jk	Post in mound			
jl	Post in mound			
jm	Post in mound			
jn	Post in mound			
jo	Post in mound			
jp	Post in mound			
jq	Post in mound			
jr	Post in mound			
js	Post in mound			
jt	Post in mound			
ju	Post in mound			
jv	Post in mound			
jw	Post in mound			
jx	Post in mound			
iy	Post in mound			
iz	Post in mound			
ka	Post in mound			
kb	Post in mound			
kc	Post in mound			
kd	Post in mound			
ke	Post in mound			
kf	Post in mound			
kg	Post in mound			
kh	Post in mound			
ki	Post in mound			
kj	Post in mound			
kk	Post in mound			
kl	Post in mound			
km	Post in mound			
kn	Post in mound			
ko	Post in mound			
kp	Post in mound			
kq	Post in mound			
kr	Post in mound			
ks	Post in mound			
kt	Post in mound			
ku	Post in mound			
kv	Post in mound			
kw	Post in mound			
kx	Post in mound			
ky	Post in mound			
kz	Post in mound			
la	Post in mound			
lb	Post in mound			
lc	Post in mound			
ld	Post in mound			
le	Post in mound			
lf	Post in mound			

Township N^o 29 N. Range N^o 4 W. 2nd Mer.

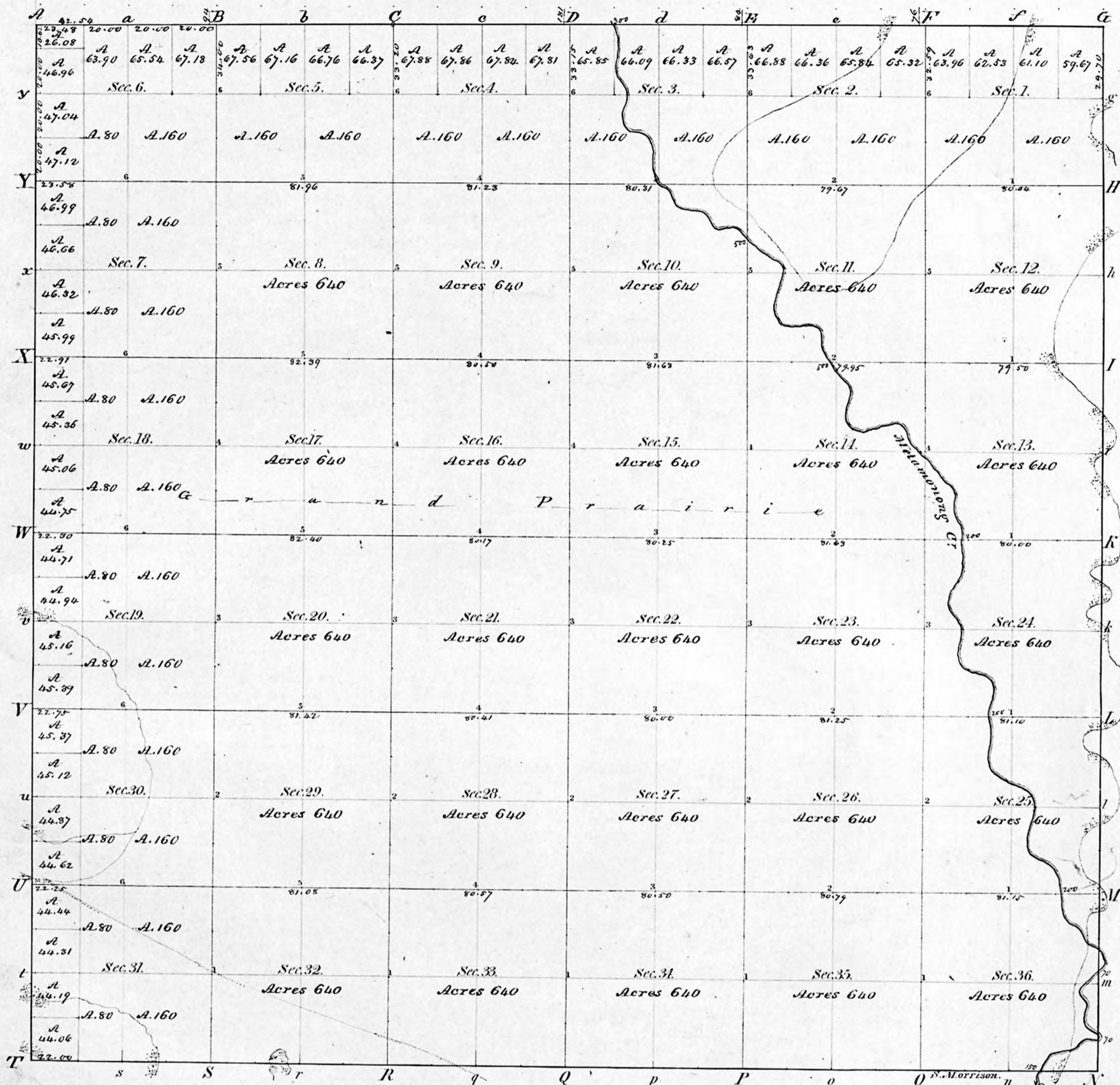

Surveyed in 1837 by Hanna Robert, Deputy Surveyor.



I certify that the above is a true copy of the Original plot in this Office.
 Surveyor General's Office, Lucius Lyon,
 Detroit Nov. 1, 1849

Sur. Gen!