

Quality of the Soil, Timber, &c. on the Township Lines.		East Boundary.	
Sec. 36	Land level barrens, very thin timber, W & Y. Oak &c	Sec. 36	Land level and soil good, timber W & Y. Oak &c
" 25	Land, except prairie, similar, prairie good soil, some heavy level	" 35	Same
" 24	Land level good soil, thin timber, Small Oak & Hickory &c	" 34	Same
" 13	Land level prairie good soil &c	" 33	Land low and 2 nd rate, thin timber with Oak
" 12	Land barrens, good soil, prairie &c	" 32	Same
" 1	This mile large prairie, part wet and part dry &c	" 31	Land level soil good, timber W & Y. Oak & Hickory &c
South Boundary.		East Boundary.	
35, 36,	Land level 3 rd rate barrens, timber scarce W & Y. Oak &c	35, 36,	Same
25, 36,	Same	25, 26,	Land marshy wet barrens scarce of timber, B & M. Oak &c
24, 25,	Land level wet barrens 3 rd rate, a few scattering trees, Hickory, B & M. Oak &c	23, 24,	Land 2 nd rate barrens, scarce of timber of any kind, a few B & M. Oak, Hickory &c
23, 24,	Land level barrens, wet with but few trees of any kind	13, 24,	Land level barrens, wet with but few trees of any kind
13, 14,	Land level 3 rd rate barrens, a few scattering trees, Bar, B & M. Oak, Hickory &c	12, 13,	Water all over
11, 12,	Wet barrens, flag swamp, no trees	11, 12,	Wet barrens, flag swamp, no trees
1, 12,	Land level wet barrens, timber B & M. Oak &c	1, 2,	Land wet barrens, few trees, B & M. Oak &c
34, 35,	Land fourth part of this line wet barrens, scattering trees, B & M. Oak &c	26, 35,	The east half mile rolling barrens with some timber, 3 rd rate W & Y. Oak, West half mile flag swamp in timber
26, 35,	Land marshy wet barrens scarce of timber of any kind	26, 27,	Land marshy wet barrens scarce of timber of any kind
23, 26,	The whole of this line runs through barrens, scarce of timber, West half mile entirely through a marsh	22, 23,	Land 2 nd rate barrens, W & Y. Oak &c, Undergrowth &c
14, 23,	East half mile 2 nd rate barrens, West half mile 2 nd rate, B & M. Oak, Hickory &c	14, 15,	Land 3 rd rate barrens, scattering trees, W & Y. Oak, Undergrowth &c
11, 14,	West half entirely low marshy barrens, East half 2 nd rate, B & M. Oak &c	10, 11,	Land 2 nd rate level Bar, B & M. Oak &c
2, 11,	The whole of this line runs through open barrens, a few scattering trees W & Y. Oak &c	2, 3,	Land extremely wet barrens, scattering W & Y. Oak &c
33, 34,	Land wet barrens timber scarce, B & M. Oak &c	27, 34,	Land level and wet barrens with but little timber of any kind
27, 34,	Land level and wet barrens with but little timber of any kind	27, 28,	Land &c same
22, 27,	Land level and wet barrens with some small groves of W & Y. Oak &c	21, 22,	Land level and wet barrens scarce of timber of any kind
15, 22,	Land level and wet barrens, some small groves of W & Y. Oak &c	15, 16,	Land level and wet barrens interspersed with groves of timber, W & Y. Oak &c
10, 15,	Land level 2 nd rate, W & Y. Oak, Hickory, Undergrowth &c	9, 10,	Land dry barrens 2 nd rate B & M. Oak, Hickory &c
3, 10,	Land level B & M. Oak, Hickory &c	3, 4,	Land 2 nd rate, timber B & M. Oak, Hickory &c
32, 33,	Land 2 nd rate barrens, some places marshy, Bar & M. Oak scarce of either	28, 33,	Land wet barrens, timber, when there is any, W & Y. Oak
28, 29,	Land 3 rd rate marshy barrens, B & M. Oak &c	21, 28,	Land 2 nd rate barrens, Hickory, Oak &c
20, 21,	Dry barrens 2 nd rate, with groves of W & Y. Oak &c	16, 21,	Land level dry barrens, W & Y. Oak, Undergrowth, same where there is any
16, 17,	Land level 3 rd rate barrens, Hickory & Oak, Undergrowth &c same	9, 16,	Land 3 rd rate wet barrens, Hickory, scattering trees of W & Y. Oak &c
8, 9,	Land 2 nd rate W & Y. Oak, Bar, Oak, Hickory, Undergrowth &c	4, 9,	Land 3 rd rate, W & Y. Oak, Hickory &c
4, 5,	Land 3 rd rate generally dry barrens, W & Y. Oak, Hickory &c	31, 32,	Land 2 nd rate barrens, timber, W & Y. Oak, Hickory &c
29, 32,	Land 2 nd rate barrens, B & M. Oak, Hickory &c	30, 31,	Land level 2 nd rate, W & Y. Oak, Linn, Sycamore, Walnut & Hickory, Undergrowth &c
29, 30,	Land level marshy barrens, timber scarce W & Y. Oak, Hickory &c	20, 29,	Land level marshy barrens, timber &c same
19, 30,	Land dry barrens 2 nd rate, B & M. Oak, Hickory &c	19, 20,	Land 2 nd rate dry barrens, W & Y. Oak, Hickory &c
17, 20,	Land level dry barrens, a few trees, W & Y. Oak, Undergrowth &c	18, 19,	Land dry barrens 2 nd rate, Hickory, W & Y. Oak, Undergrowth, Hazel, W. Oak, Hickory &c
17, 18,	Land level dry barrens, B & M. Oak, Hickory, Sycamore & Undergrowth &c	8, 17,	Land on each side 2 nd rate dry barrens timber B & M. Oak &c
7, 18,	Land level wet barrens, B & M. Oak where there is any	7, 8,	Land level dry barrens, timber same
5, 8,	Land dry barrens scarce of timber, a few B & M. Oak &c	6, 7,	Land level 3 rd rate barrens, a few W & Y. Oak
5, 6,	Land level wet barrens with groves of J. Oak, W & Y. Oak, with little Undergrowth &c		

Corners on Hippocrene River				
Posts.	Bearing Trees.	Inches diam'r.	Courses they bear.	Links distant
1	Sycamore	6	S. 50 E.	.20
	H. Oak	12	S. 50 W.	.66
2	H. Oak	5	Corner	
3	B. Oak	30	S. 26 W.	.97
	W. Oak	20	S. 21 E.	1.07
4	B. Ash	30	S. 55 E.	.55
	Bur Oak	30	S. 20 W.	.64
5	B. Oak	25	S. 30 E.	.27
	Ditto	23	S. 49 E.	.33
6	W. Oak	-	S. 55 W.	1.32
	Ditto	-	S. 16 W.	3.90
7	W. Oak	15	S. 31 E.	3.50
	B. Oak	25	S. 50 E.	3.90
8	B. Oak	4	S. 55 E.	.16
	W. Oak	4	S. 73 W.	.11
9	B. Oak	20	S. 11 W.	1.43
	Ditto	36	S. 60 E.	.80
10	B. Oak	24	S. 65 E.	1.17
	Ditto	36	S. 53 E.	1.44
11	B. Oak	-	S. 57 E.	.27
	Hickory	15	S. 14 W.	.31
12	W. Oak	20	S. 78 E.	.43
	Ditto	15	S. 31 E.	.54
13	B. Oak	10	Corner	
14	B. Oak	35	S. 29 W.	.31
	Ditto	35	S. 29 W.	1.00
15	W. Oak	30	S. 17 W.	.13
	B. Oak	27	S. 33 W.	.75
16	Bur Oak	6	S. 56 W.	.10
	Sassafras	4	S. 7 W.	.6
17	Bur Oak	6	S. 8 E.	.67
	B. Oak	8	S. 32 E.	.62
18	Lynn	20	S. 41 E.	.33
	Elm	30	S. 42 W.	.33
19	H. Oak	18	S. 79 W.	.57
	Ditto	20	S. 43 E.	.53
20	Maple	12	S. 40 E.	.41
	Y. Birch	10	S. 40 W.	.62
21				
22				
23				
24				
25				
26				
27				
28				
29				
30				
31				
32				
33				
34				
35				
36				
37				

The figures in this column refer to the Posts numbered in red ink on the Plans.

Description of the Land, Timber, &c. on the Interior Sectional Lines.

Township No. 29 North, Range No. 2 West 2nd Meridian, Indiana

Exterior Section and Quarter Section Corners Described.

Interior Quarter Section Corners Described.

Main table with columns for Post, Bearing Trees, Inches diam'r, Courses they bear, Links distant. Includes sub-sections for Interior Section Corners and various corner descriptions (e.g., M to U at 1, P to E at 1).

Township N^o 29 N. Range N^o 2 W. 2^d Mer.

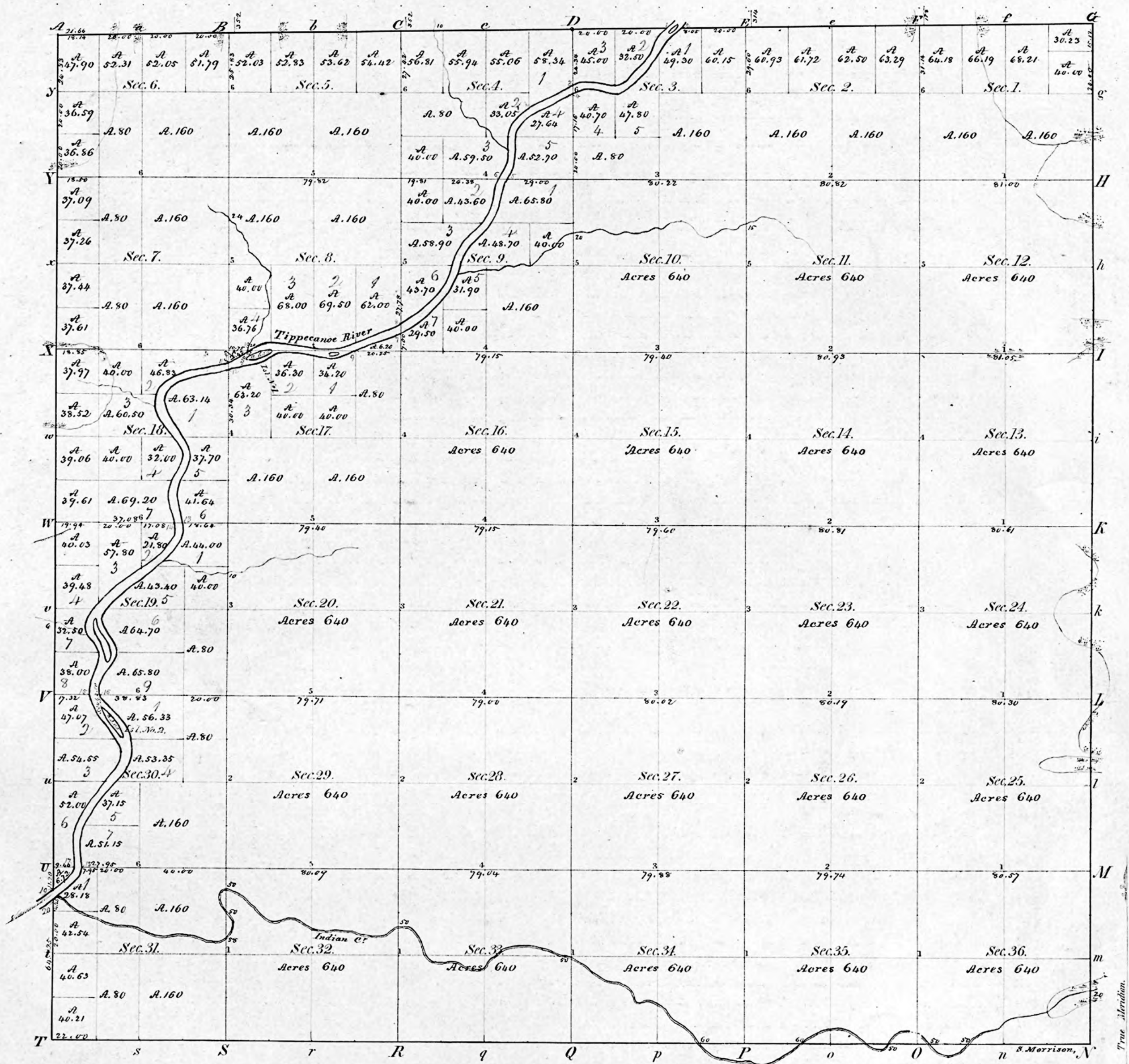

Surveyed in 1834 by Robert Hanna Deputy Surveyor.

Scale, 40 chains to an Inch.

I certify that the above is a true copy of the Original plat in this Office.
 Surveyor General's Office, Lucius Lyon,
 Detroit Nov. 1, 1849

Sur. Genl