

Quality of the Soil, Timber, &c. on the Township Lines.		Description of the Land, Timber, &c. on the Interior Sectional Lines.				
East Boundary.		South Boundary.				
Sec. 36	Mostly wet prairie - a few Oaks on N. E.	35, 36	Level wet barrens - W. & N. Oaks.			
" 25	Rolling 2 <sup>nd</sup> rate - W. & N. Oaks - U.S. same.	25, 36	Same			
" 24	Level 2 <sup>nd</sup> rate. Timber &c. same.	25, 26	Part dry barrens & part flag & bullrush swamp - W. & N. Oaks &c.			
" 13	Same	24, 25	Level 2 <sup>nd</sup> rate - W. & N. Oaks &c.			
" 12	Nearby 2 <sup>nd</sup> rate. Oaks.	23, 24	Level 3 <sup>rd</sup> rate - part dry & part wet barrens - W. & N. Oaks.			
" 1	Level 2 <sup>nd</sup> rate - W. & N. Oaks.	13, 24	E. & 3 <sup>rd</sup> rate - W. & N. Oaks & Hickory - N. & wet barrens & no timber.			
		13, 14	Nearly all marsh.			
		12, 13	Level flag & bullrush swamp covered with water.			
		11, 12	Level wet prairie - W. & N. Oaks &c.			
		1, 12	Same			
		1, 2	Mostly swamp - scarce of timber.			
		34, 35	Level wet barrens - W. & N. Oaks.			
		26, 35	Same			
		26, 27	Same			
		23, 26	Same			
		22, 23	Principally flag & bullrush swamp - Aspen, W. & N. Oaks &c.			
		14, 23	Level wet prairie - flag & bullrush swamp			
		14, 15	All flag & bullrush swamp			
		11, 14	Nearby - No timber scarcely.			
		10, 11	Part wet & part dry barrens - no timber scarcely.			
		2, 11	Dry barrens timber scarce - W. & N. Oaks.			
		2, 3	Same			
		33, 34	Part timbered - part prairie.			
		27, 34	Generally dry barrens - a few groves of W. & N. Oaks, Hickory &c.			
		27, 28	Level wet prairie			
		22, 27	Mostly same - small groves of W. & N. Oaks.			
		21, 22	Mostly flag & bullrush swamp.			
		15, 22	All marsh & swamp.			
		15, 16	2 <sup>nd</sup> rate level prairie - Scattering W. & N. Oaks.			
		10, 15	E. & all swamp - W. & dry barrens 2 <sup>nd</sup> rate - W. & N. Oaks.			
		9, 10	Level dry prairie - 2 <sup>nd</sup> rate.			
		3, 10	2 <sup>nd</sup> rate barrens - flag & bullrush swamp - W. & N. Oaks.			
		3, 4	Wet barrens - no timber scarcely.			
		32, 33	Level dry prairie - some groves of Oaks.			
		28, 33	Level wet prairie.			
		28, 29	Principally dry prairie - small groves of W. & N. Oaks.			
		21, 28	Level dry prairie.			
		20, 21	Level 2 <sup>nd</sup> rate barrens - W. & N. Oaks &c.			
		16, 21	N. & wet - E. & dry prairie - 2 <sup>nd</sup> rate.			
		16, 17	Dry barrens - W. & N. Oaks.			
		9, 16	E. & 2 <sup>nd</sup> rate prairie - W. & wet barrens - scarce of timber.			
		8, 9	Wet & mostly level prairie.			
		4, 9	Level - part wet & part dry prairie.			
		4, 5	Level wet prairie - W. & N. Oaks &c.			
		31, 32	Principally dry prairie - 2 <sup>nd</sup> rate.			
		29, 32	Mostly wet prairie.			
		30, 31	Level wet prairie.			
		29, 30	Greater part prairie - 2 <sup>nd</sup> rate - Some groves of W. & N. Oaks.			
		20, 29	Generally dry prairie - 2 <sup>nd</sup> rate.			
		19, 30	Level wet barrens - W. & N. Oaks.			
		19, 20	Level wet prairie - groves of Oaks.			
		17, 20	E. & wet prairie - W. & dry barrens - W. & N. Oaks.			
		18, 19	Level open barrens - part dry & part flag & bullrush swamp - W. & N. Oaks.			
		17, 18	Barrens - part wet & part dry.			
		8, 17	Level wet barrens - bullrush & flag swamp - groves of W. & N. Oaks &c.			
		7, 18	Level open barrens - W. & N. Oaks scattering.			
		7, 8	2 <sup>nd</sup> rate prairie.			
		5, 8	E. & level barrens - W. & N. Oaks - W. & wet prairie.			
		6, 7	E. & 2 <sup>nd</sup> rate prairie - W. & wet barrens - W. & N. Oaks.			
		5, 6	2 <sup>nd</sup> rate level barrens.			

The figures in this column refer to the Posts numbered in red ink on the Plans.

Posts.	Bearing Trees.	Inches diam'r.	Courses they bear.	Links distant
1				
2				
3				
4				
5				
6				
7				
8				
9				
10				
11				
12				
13				
14				
15				
16				
17				
18				
19				
20				
21				
22				
23				
24				
25				
26				
27				
28				
29				
30				
31				
32				
33				
34				
35				
36				
37				

Exterior Section and Quarter Section Corners Described.

Interior Quarter Section Corners Described.

Main table containing corner descriptions for sections A through U, including bearing trees, inches diam'r., courses they bear, and links distant. Includes sub-sections for Interior Section Corners and various quarter-section corner descriptions.

Township N<sup>o</sup> 30N. Range N<sup>o</sup> 4W. 2<sup>nd</sup> Mer.

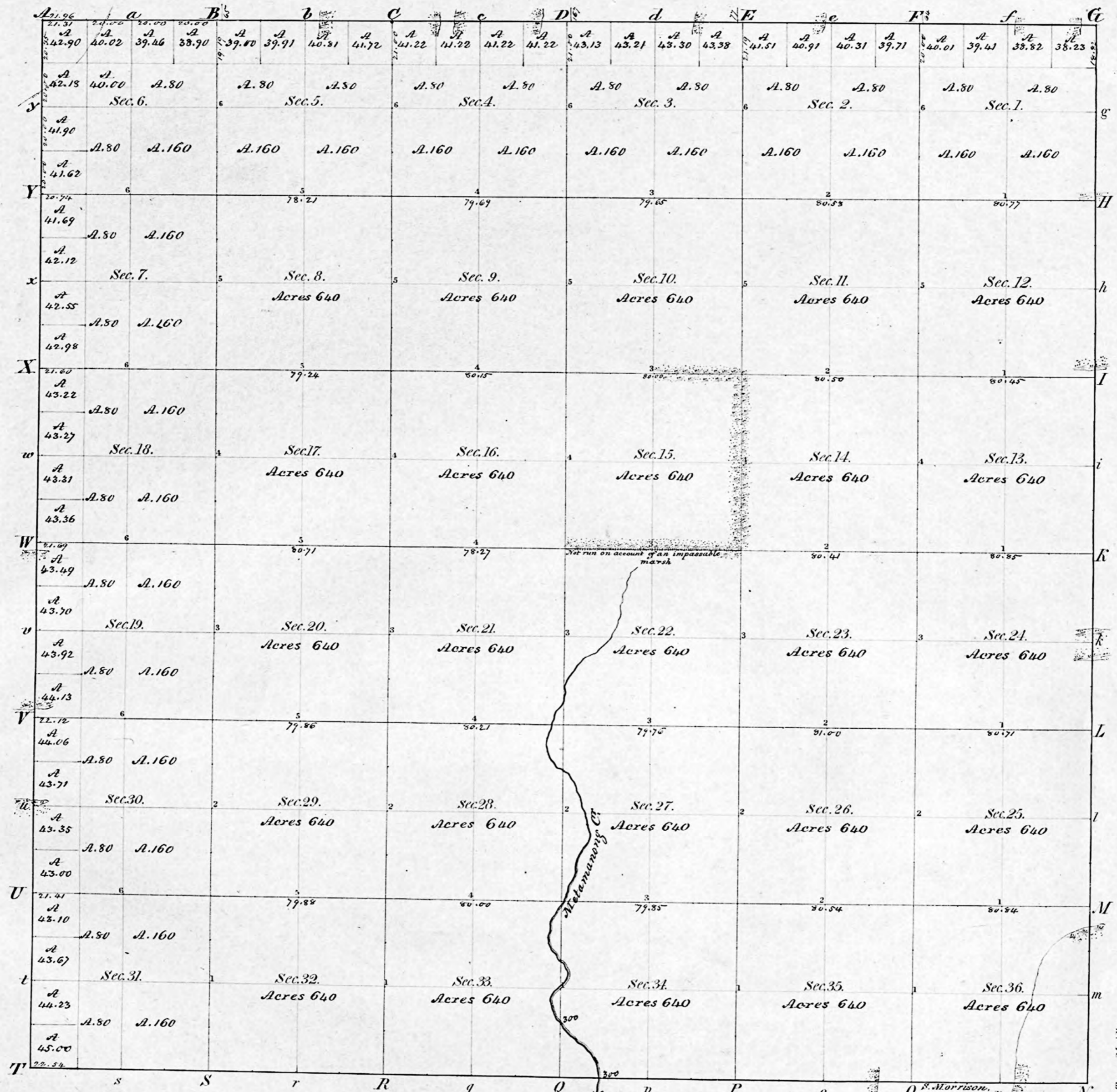

Surveyed in 1835 by Robert Hanna, Deputy Surveyor.

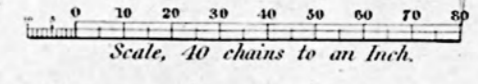

I certify that the above is a true copy of the Original plot in this Office.

Surveyor General's Office, Lucius Lyon, Sur. Gen.  
 Detroit Nov. 1. 1849