

Quality of the Soil, Timber, &c. on the Township Lines		East Boundary.		Common on Tippecanoe River.				
South Boundary.		Sec.	Description	Posts.	Bearing Trees.	Inches diam'r.	Courses they bear.	Links distant
		Sec. 36	Rolling & 1 <sup>st</sup> rate barrens - Timber of W. & Burr Oak - Undergrowth same.					
		" 25	Rolling & 2 <sup>d</sup> rate - W. & B. Oak.					
		" 24	Same.					
		" 13	Rolling & 2 <sup>d</sup> rate - Thinly timbered with W. & B. Oak, &c.					
		" 12	Same.					
		" 1	Mainly wet prairie - a few Oaks.					
		Sec. 36	Rolling & 1 <sup>st</sup> rate - W. & B. Oak.					
		" 35	Rolling - 1 <sup>st</sup> rate - level - soil good - Timber Oak.					
		" 34	Flat & 2 <sup>d</sup> rate - Oak.					
		" 33	Low & wet - soil thin - W. & B. Oak.					
		" 32	Same.					
		" 31	Level & good - thinly timbered with Oak.					
		35, 36,	1 <sup>st</sup> rate barrens - Burr & Black Oak, Hickory &c.					
		25, 36,	2 <sup>d</sup> rate barrens - timber scarce - Burr, Black, & White Oak &c.					
		25, 26,	Wet barrens.					
		24, 25,	Level dry barrens - timber scarce - W. & B. Oak &c.					
		23, 24,	Level wet barrens - W. & B. Oak &c.					
		13, 24,	Same.					
		13, 14,	Level dry barrens - W. & B. Oak, &c.					
		12, 13,	Level wet barrens - timber scarce - W. & B. Oak &c.					
		11, 12,	Level - part wet & part dry barrens - 2 <sup>d</sup> rate - Timber scarce of any kind.					
		1, 12,	Level wet barrens - timber scarce - W. & B. Oak.					
		1, 2,	Four-fifths of this line runs through a flag & bull-rush swamp - a few groves of W. & B. Oak.					
		34, 35,	Mostly 2 <sup>d</sup> rate barrens - timber scarce - W. & B. Oak.					
		26, 35,	2 <sup>d</sup> rate - W. & B. Oak &c. Several cuts of this line run through water mid-high deep.					
		26, 27,	2 <sup>d</sup> rate - part wet flag swamp, part dry barrens - W. & B. Oak.					
		23, 26,	Wet barrens - flag & bull-rush swamp - a few Oaks.					
		22, 23,	Mostly wet barrens - a few trees - W. & B. Oak.					
		14, 23,	Level 2 <sup>d</sup> rate, mostly flag & bull-rush swamp - W. & B. Oak, Hickory &c.					
		14, 15,	Mostly level wet barrens - flag & bull-rush swamp - W. & B. Oak, Hickory &c.					
		11, 14,	W. & B. wet barrens, a few trees, W. & B. Oak, W. & B. flag & bull-rush swamp, &c.					
		10, 11,	Most of this line runs through wet barrens - some groves - W. & B. Oak, Hickory &c.					
		2, 11,	Mostly wet barrens - W. & B. Oak, W. & B. Oak.					
		2, 3,	Level last rate barrens - W. & B. Oak - long Oak & Whiteberry.					
		33, 34,	Level mostly dry barrens - 2 <sup>d</sup> rate - W. & B. Oak &c.					
		27, 34,	The greater part of this line runs through marshy barrens, water in places mid-high deep - small groves of W. & B. Oak.					
		27, 28,	Level wet barrens - bull-rush swamp in places a few trees - W. & B. Oak - long Oak & Whiteberry &c.					
		22, 27,	All flag & bull-rush swamp, except a few chains at W. end dry barrens - no timber.					
		21, 22,	Greater part wet barrens - scattering trees - W. & B. Oak.					
		15, 22,	Level most part wet barrens - a few trees of W. & B. Oak.					
		15, 16,	Same.					
		10, 15,	Same.					
		9, 10,	All marshy barrens - a few trees - Oak & Ash.					
		3, 10,	Two-thirds marshy barrens, flag & bull-rush swamp - the remainder dry barrens - W. & B. Oak.					
		3, 4,	All flag & bull-rush swamp - a few small groves - Ash &c.					
		32, 33,	Mostly wet barrens - a few groves of W. & B. Oak - flag & bull-rush swamp.					
		28, 33,	W. & B. dry barrens - 2 <sup>d</sup> rate - W. & B. flag swamp - timber W. & B. Oak.					
		28, 29,	Mostly swamp, mid-high deep - a few groves of Ash, W. & B. Oak & B. Gum.					
		21, 28,	This line is on the margin of a large body of water mid-high deep in places; a few groves &c.					
		20, 21,	Level wet barrens - timber scarce - W. & B. Oak.					
		16, 21,	Level barrens - timber scarce - W. & B. Oak.					
		16, 17,	Level wet barrens - timber scarce - W. & B. Oak.					
		9, 16,	Level barrens - timber scarce - W. & B. Oak.					
		8, 9,	Level marshy prairie - W. & B. Oak.					
		4, 9,	Level - small groves of W. & B. Oak & Ash.					
		4, 5,	Level wet prairie - small groves of W. & B. Oak &c.					
		31, 32,	Level dry barrens - W. & B. Oak & Hickory &c.					
		29, 32,	Level dry barrens - 2 <sup>d</sup> rate - scarce timber - W. & B. Oak &c.					
		30, 31,	Level dry barrens - timber scarce - groves of W. & B. Oak &c.					
		29, 30,	Level generally dry barrens - W. & B. Oak &c.					
		20, 29,	Level dry barrens - W. & B. Oak.					
		19, 30,	Principally dry barrens - W. & B. Oak, W. & B. Oak.					
		19, 20,	Level dry barrens - timber scarce - W. & B. Oak.					
		17, 20,	Level wet barrens - timber scarce - small groves of W. & B. Oak.					
		18, 19,	Level - W. & B. wet - W. & B. dry prairie - small groves of W. & B. Oak.					
		17, 18,	Level part wet & part dry barrens - timber scarce of any kind.					
		8, 17,	Level wet barrens - groves of W. & B. Oak.					
		7, 18,	Same.					
		7, 8,	Generally wet prairie - small groves of W. & B. Oak & Ash &c.					
		5, 8,	Level marshy prairie - small groves of W. & B. Oak & Ash &c.					
		6, 7,	Level wet barrens - small groves of W. & B. Oak &c.					
		5, 6,	Level wet prairie - small groves of W. & B. Oak &c.					

The figures in this column refer to the Posts numbered in red ink on the Plate.

Exterior Section and Quarter Section Corners Described.

Interior Quarter Section Corners Described.

Table with columns: Posts, Bearing Trees, Inches diam'r., Courses they bear, Links distant. Rows A through U.

Table with columns: Qr. Sec. Posts on the Lines, Bearing Trees, Inches diam'r., Courses they bear, Links distant. Rows M to U at 1, L to V at 1, K to W at 1, I to X at 1, H to Y at 1, O to F at 1.

Interior Section Corners Described.

Table with columns: Corners of Sections, Bearing Trees, Inches diam'r., Courses they bear, Links distant. Rows 1 through 36.

Table with columns: Qr. Sec. Posts on the Lines, Bearing Trees, Inches diam'r., Courses they bear, Links distant. Rows M to U at 1, L to V at 1, K to W at 1, I to X at 1, H to Y at 1, O to F at 1.

Township N<sup>o</sup> 29 N. Range N<sup>o</sup> 3 W. 2<sup>nd</sup> Mer.

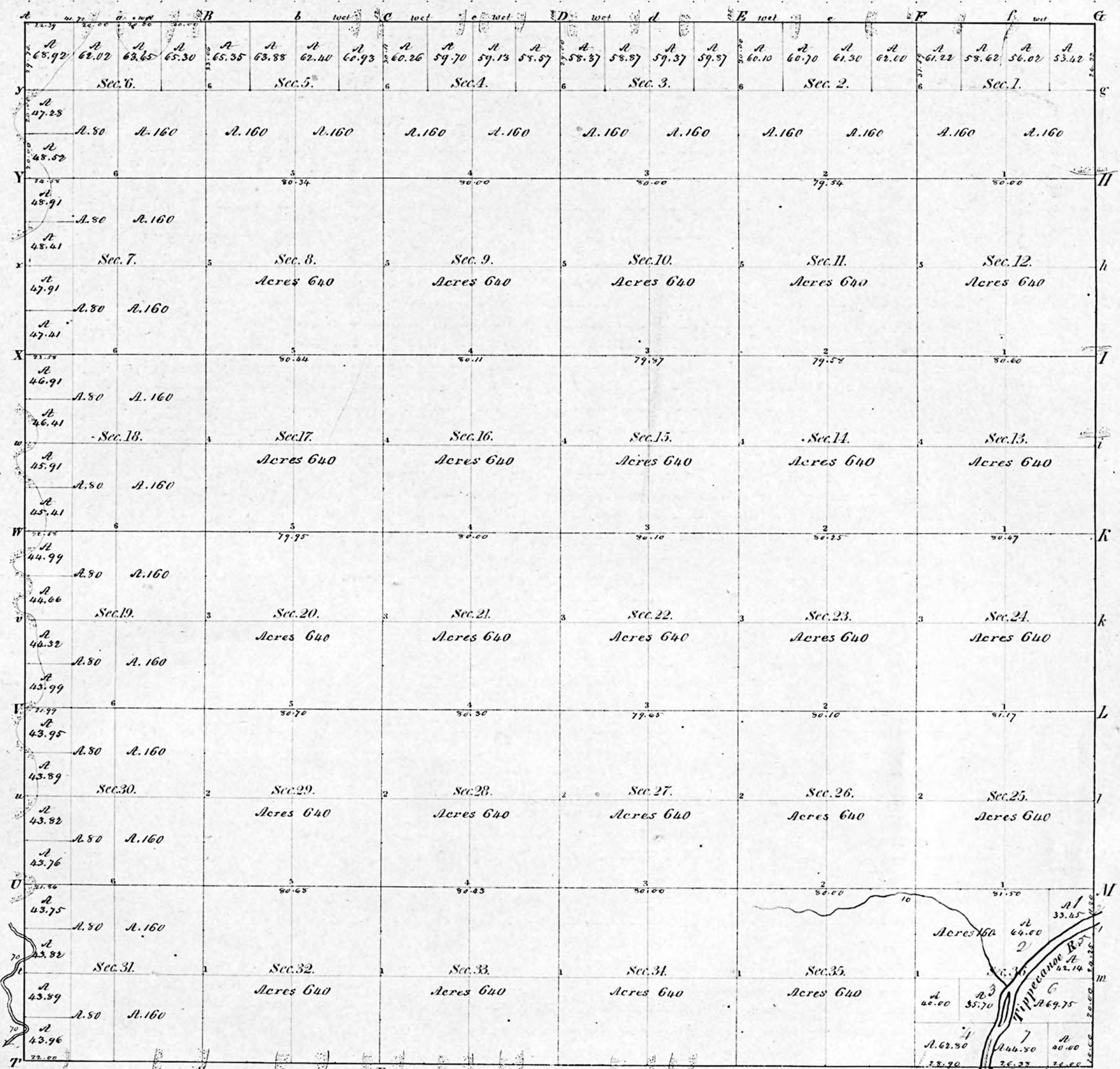

Surveyed in 1837 by Robert Hanna, Deputy Surveyor.

I certify that the above is a true copy of the Original plot in this Office.  
 Surveyor General's Office, Lucius Lyon, Sur. Gen.  
 Detroit Nov. 1. 1849

30.37  
 26.87  
 16.92